

Letter of Explanation

1690 Sandbar Ln. Pasadena, MD. 21122

Timothy & Amy Kane

**Proposed Work**

We are seeking a variance for a 13'w x 12'l boat lift and the associated poles with less setbacks than required. Two poles required will be in the setback. Poles located 10' into the setback or 5' off the western extended property line. All work a max of 120' channel ward of the mean high-water line.

**Hardship**

The Kanes property has a waterfront footage of 60'. The Kanes currently have two boat lifts on their pier which is not abnormal for The Long Point on the Magothy Community. However, their least channel ward boat lift is currently located in shallow slip. This application is seeking to relocate the existing lift to a deeper slip. The current slip has a depth of 2.5 feet at high tide and 1.5 feet at low tide. This is not adequate depth to reliably operate their boat lift or boat. If the tide is out when the Kanes return from a boat day the low water depths would not allow the Kanes to safely store their boat on their lift. The relocation of this lift eliminates this safety issue. The application we are seeking is not uncommon among the Long Point on the Magothy Community. Similar variances were recently granted at 1688 Sandbar Ln. and 1684 Twickenham Rd. The addition of the boat lifts/slips does not change the character of the Long Point on The Magothy subdivision as numerous residents have multiple boat lifts/slips.

Thank you,

Tim Glaser

Please contact Tim Glaser with any questions or information

[tim@magnumlift.com](mailto:tim@magnumlift.com)

1-800-268-5911

1901 Betson Ct.

Odenton, MD. 21113



Existing  
Layout  
1:40 Scale  
≈ Cornfield Creek ≈

The Long Point  
Improvement Assc.  
Easement

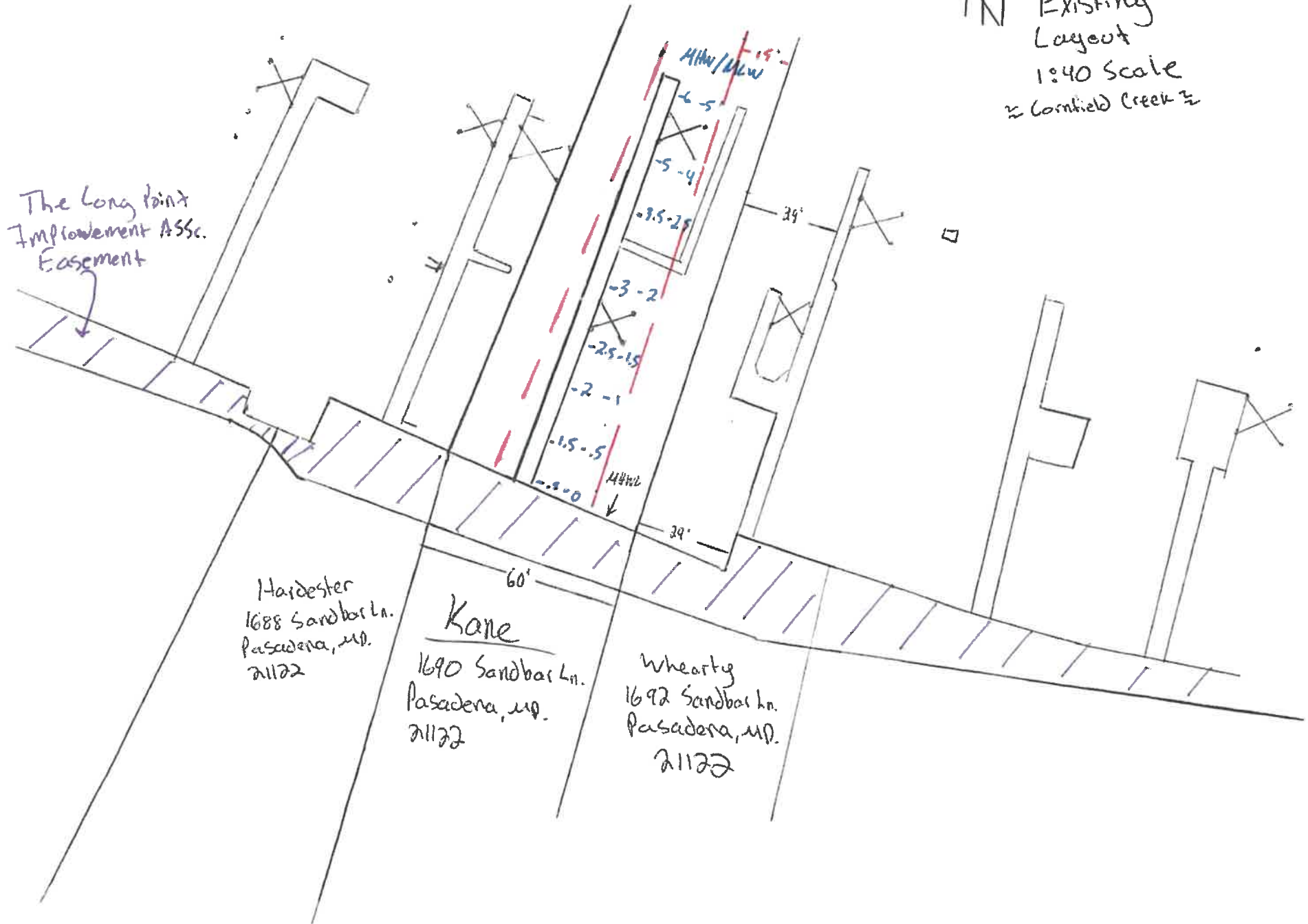



Proposed  
Layout  
1:40 Scale  
≈ Cornfield Creek ≈

Proposed  
relocation  
of Boat Lift  
w/ 2 New poles

The Long Point  
Implimentment Assc.  
Easement

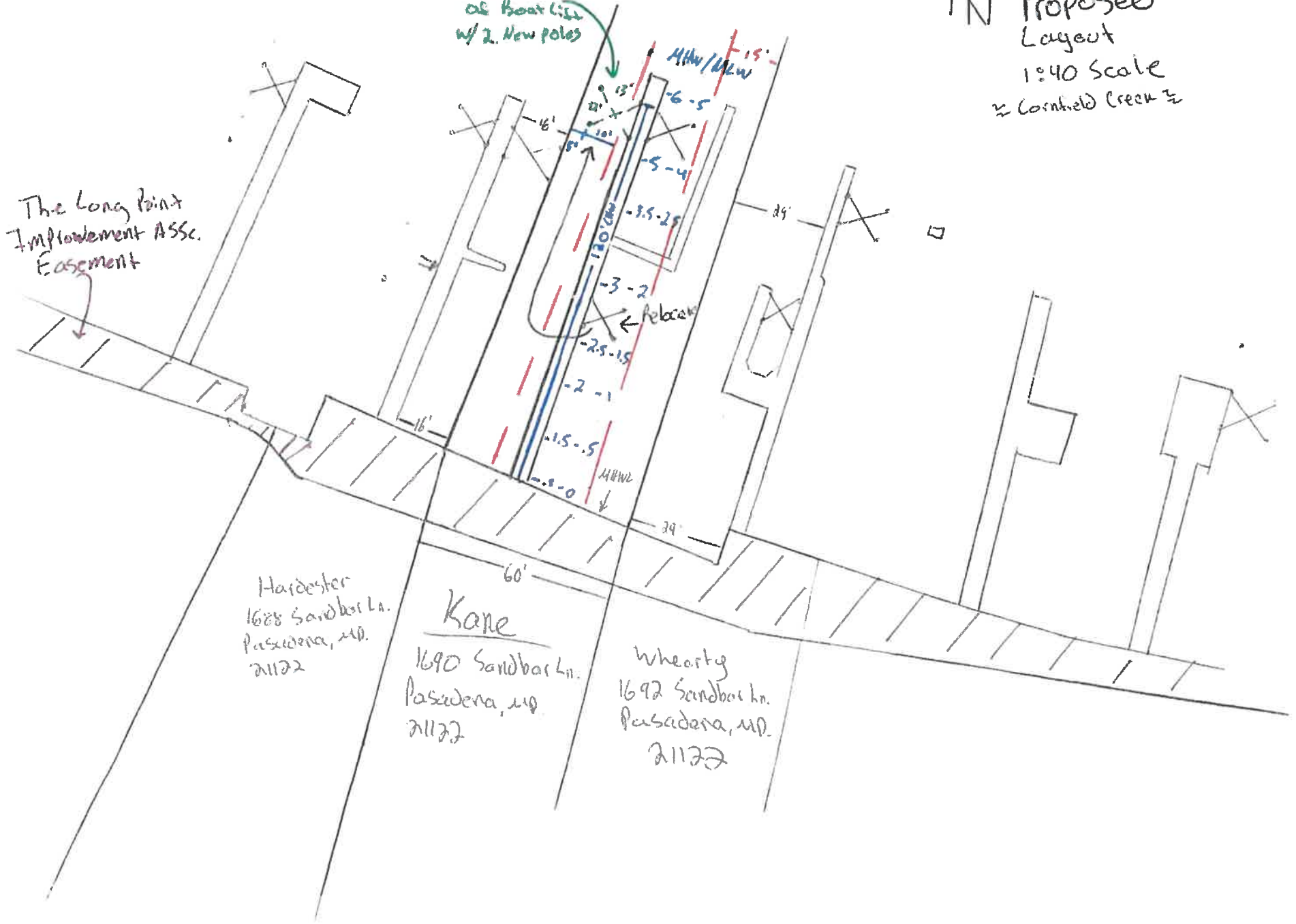

Hardester  
1688 Sandbar Ln.  
Pasadena, CA  
91122

Kane  
1690 Sandbar Ln.  
Pasadena, CA  
91122

Whearty  
1692 Sandbar Ln.  
Pasadena, CA  
91122

## GENERAL NOTES:

1. FOR LIST OF MATERIALS RELATED TO PART NUMBERS, SEE PARTS LIST.

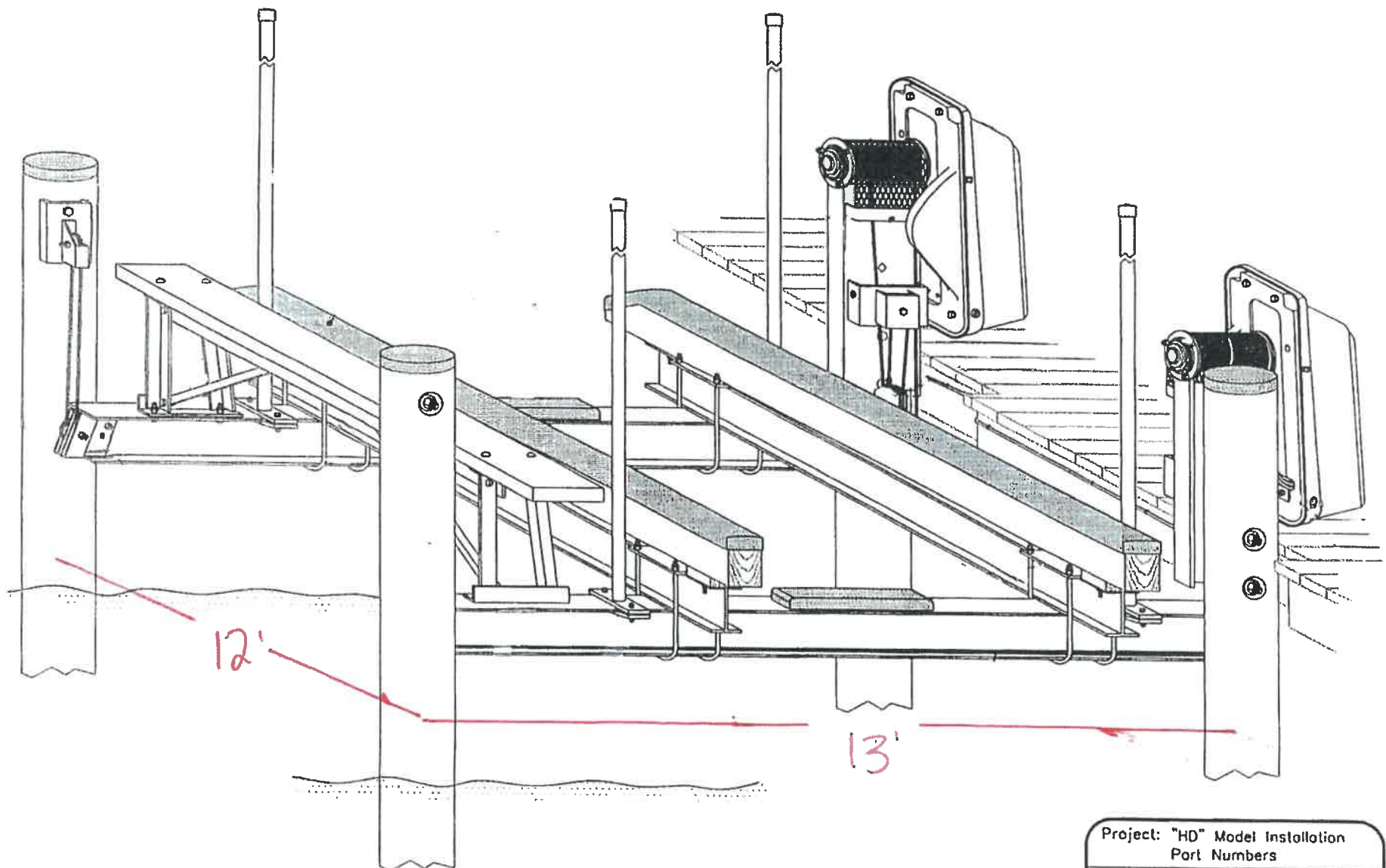

Project: "HD" Model Installation Part Numbers		
No.: 002	Revision Date:	
Scale: None	Date: 02-22-01	Sheet: 1 of 1

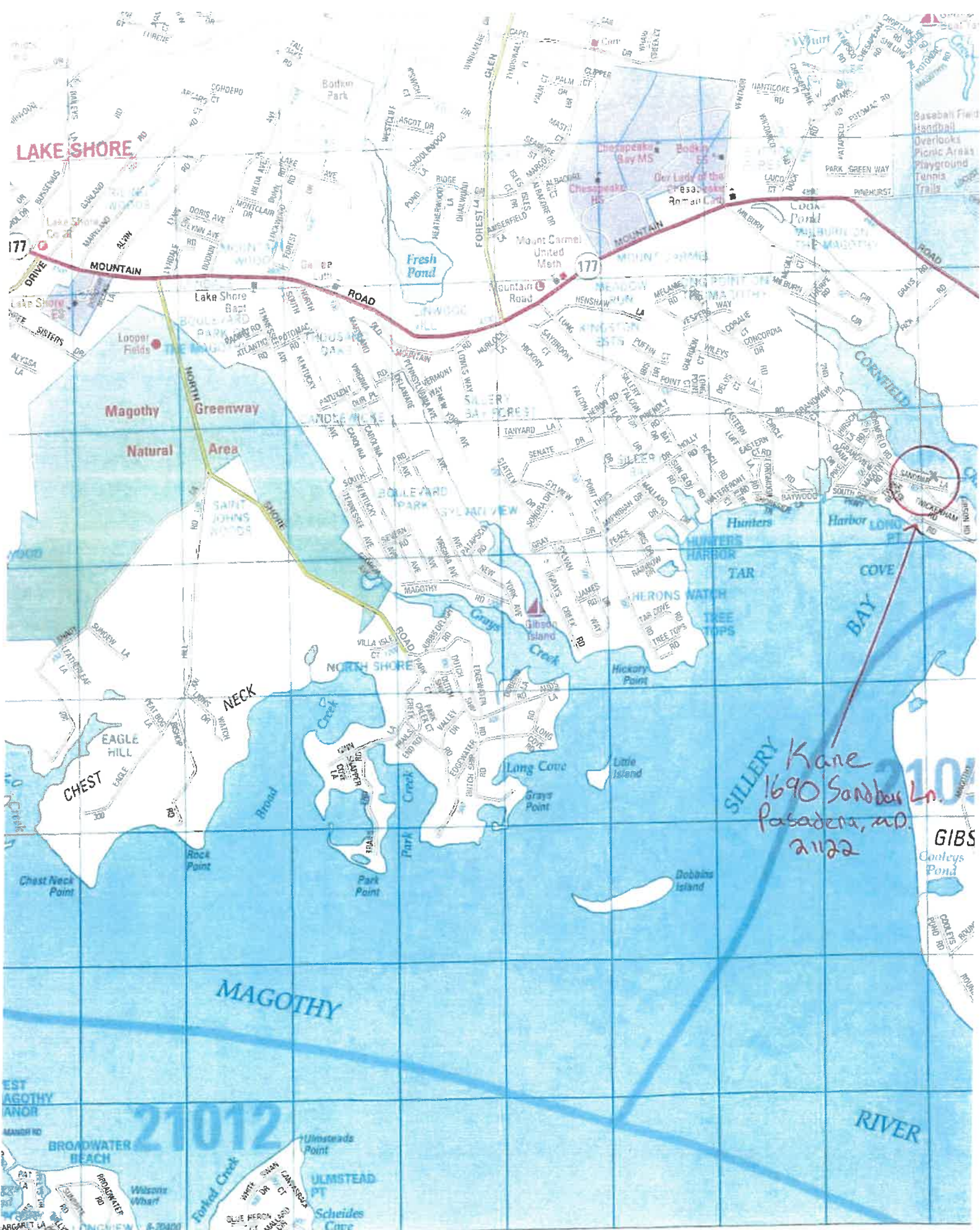



Enable clicking the map to get the coordinates ☐ ☒

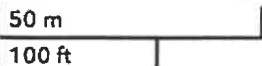

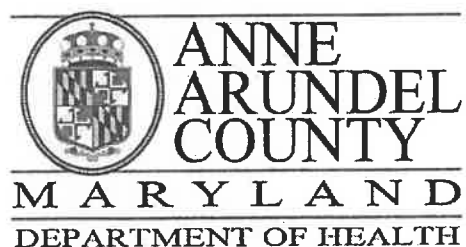

J. Howard Beard Health Services Building  
3 Harry S. Truman Parkway  
Annapolis, Maryland 21401  
Phone: 410-222-7095 Fax: 410-222-7294  
Maryland Relay (TTY): 711  
www.aahealth.org

**Tonii Gedin, RN, DNP**  
Health Officer

### MEMORANDUM

TO: Sadé Medina, Zoning Applications  
Planning and Zoning Department, MS-6301

FROM: Brian Chew, Program Manager  
Bureau of Environmental Health 

DATE: December 29, 2025

RE: Timothy C. Kane  
1690 Sandbar Lane  
Pasadena, MD 21122

NUMBER: 2025-0246-V

SUBJECT: Variance/Special Exception/Rezoning

The Health Department has reviewed the above referenced variance to allow pilings with less setbacks than required.

The Health Department has reviewed the on-site sewage disposal and well water supply system for the above referenced property. The Health Department has determined that the proposed request does not adversely affect the on-site sewage disposal and well water supply systems. The Health Department has no objection to the above referenced request.

If you have further questions or comments, please contact Brian Chew at 410-222-7413.

cc: Sterling Seay