



*Making a difference, together*

# Edgewater Recreation Center

**Public Information Session – Schematic Design**

**January 9, 2025**

**Edgewater Elementary School – 6:00pm - 7:00pm**



**DPWandYOU.com | *Making a difference, together***



# Important Meeting Information

- Tonight's meeting will be audio recorded
  - All **questions** will be answered at the **end of the presentation**.
  - Any questions that cannot be answered tonight will be added to the question and answer document that will be provided on the Department of Parks and Recreation website for this project.



# Meeting Agenda

- Project Team
- Project Background
- Project Overview
- Project Schedule
- Contact Information



# Project Team



## County Staff:

Erica Matthews  
Deputy Director  
Department of Recreation and Parks  
[drp\\_capital-projects@aacounty.org](mailto:drp_capital-projects@aacounty.org)

Kyle Autry  
Project Manager  
Department of Public Works  
[pwautr19@aacounty.org](mailto:pwautr19@aacounty.org)

## Design Consultant:

Peter Stone, Project Manager  
Pennoni and Associates



# Purpose of Meeting

This project is for the design of a community-use recreational facility in the Edgewater Area. This meeting is the Schematic 30% Design Presentation.

DRP anticipates renovating an existing building that will provide a variety of indoor active recreational and community-use opportunities.

Website for additional information regarding the the new Edgewater Rec. Center:  
<https://www.aacounty.org/recreation-parks/capital-projects/edgewater-rec-center>



# Edgewater Area Map





# Project Background:

- **Project Name:** Edgewater Regional Recreation Improvements
- **Project Number:** P592600
- **Ownership:** Anne Arundel County
- **Address:** 3130 Solomons Island, Edgewater, Md 21037
- **Zoning:** C3- General Commercial
- **Site Measures:** 5.3974 acres with a 45,797sf building and 276 parking spaces
- **Development Impact:** This project is the renovation of a developed site. This project results in no new lots or buildings. This project has no impacts on schools.

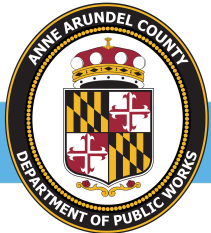

# Project Background:

## Environmental Concerns:

- There are no streams, bogs, steep slopes or floodplain on the property.
- The project is not located in the Critical Area

## Specimen Trees and Forested Area

- The LOD is less than 40,000 sf therefore this project is exempt from Forest conservation
- The site is developed with trees around the perimeter of the property.

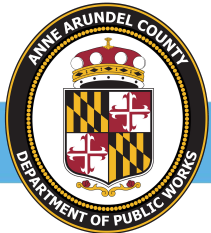



# Project Background:

## Stormwater Management:

This site would continue to use the SWM device that is currently onsite. No additional impervious area is proposed. The LOD is less than 5,000 sf so this project would be exempt from SWM.

## Utilities:

This project is served by public water and sewer

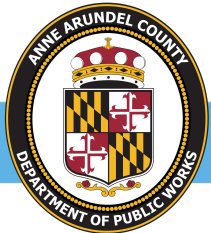

# Existing Conditions

Access to the property would continue to use the **existing driveways** located on **Solomons Island Rd** and **Southdown Rd**



# Existing Conditions

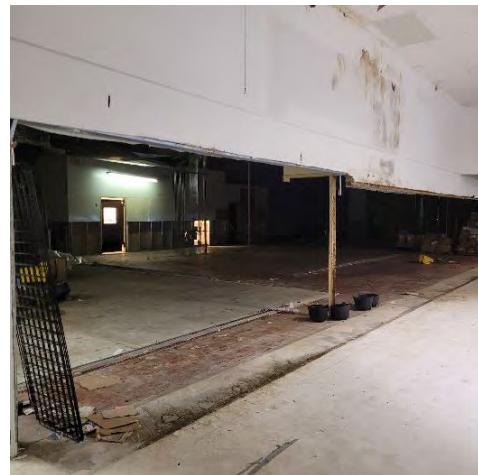
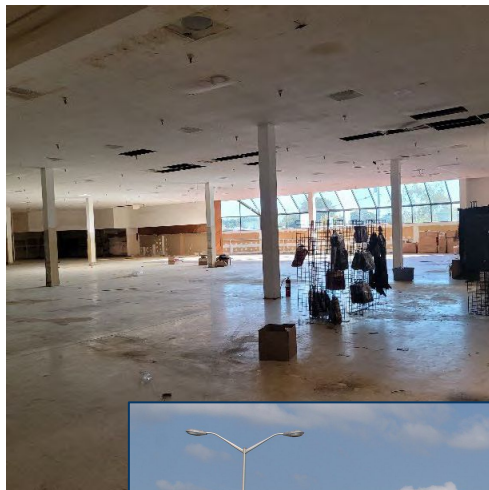

DPWandYOU.com | *Making a difference, together*



# Community Input

During a kickoff celebration at the future recreation center site, Anne Arundel County's Department of Recreation and Parks asked the public for input during a survey period dated 7/13/24-8/27/24

**974 people** participated in the survey.



DPWandYOU.com | *Making a difference, together*



# Community Input: Community Representation

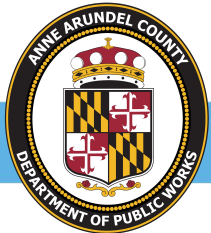
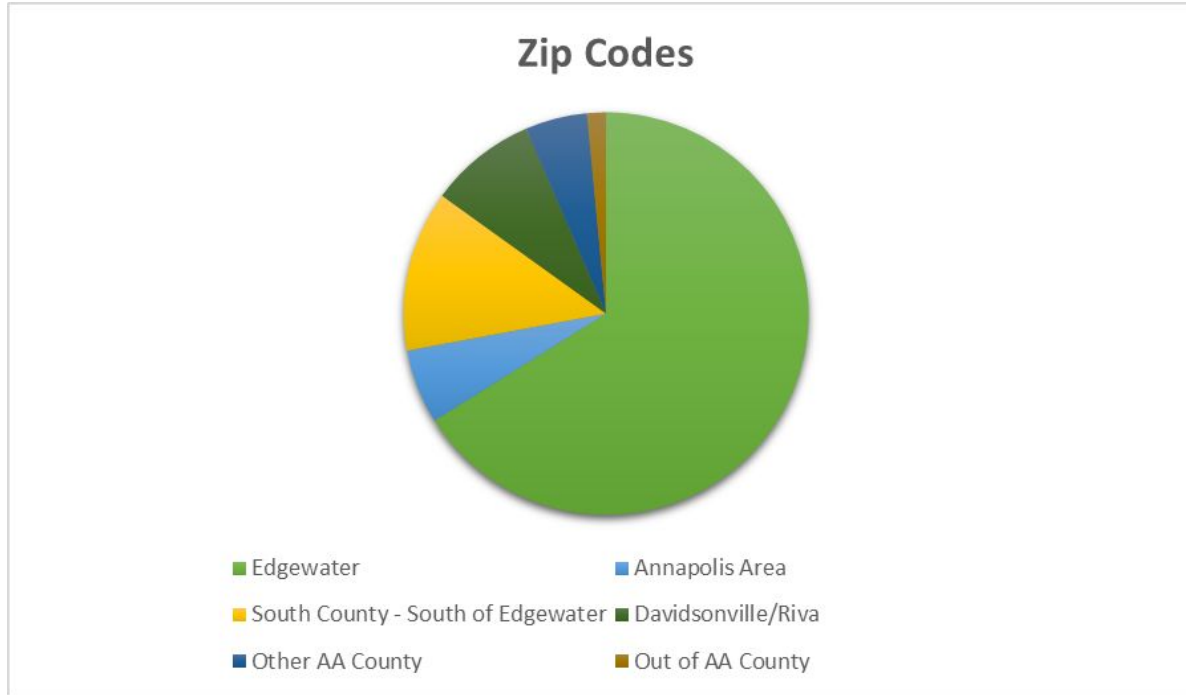

# Community Input: What type of youth programs would you like to see in this center?

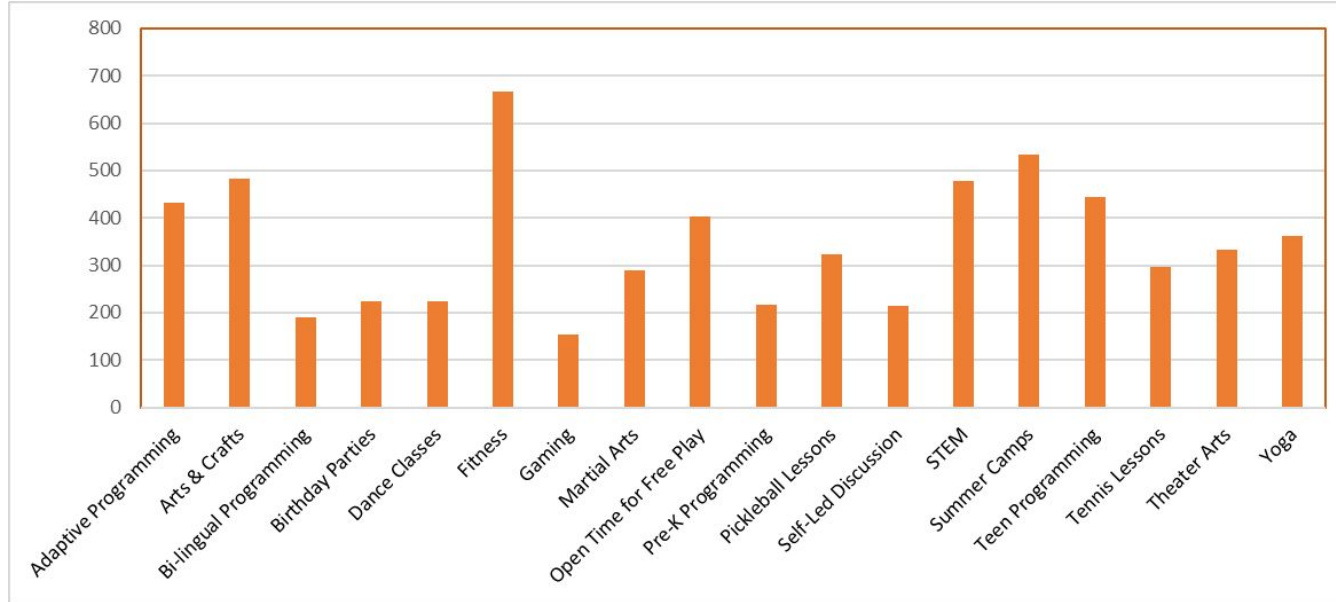



# Community Input: What types of adult programs would you like to see in this center?

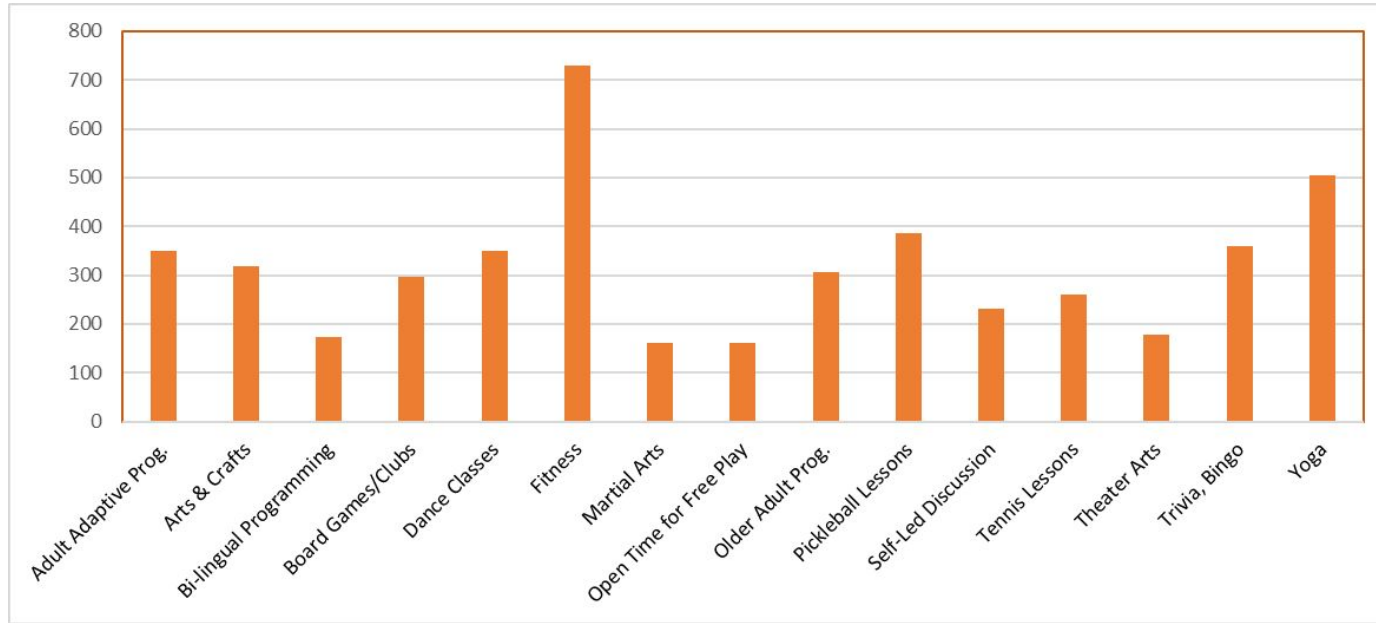



# Community Input: What Outside Amenities Would you Like to See?

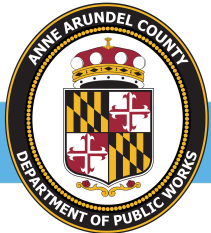
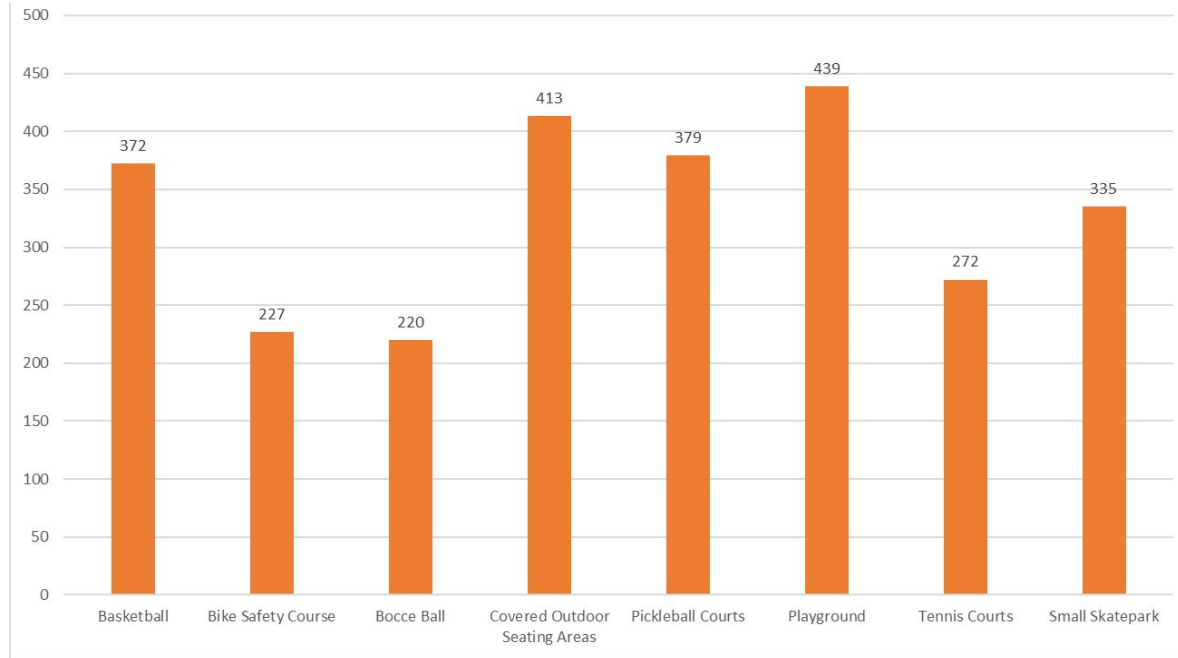

DPWandYOU.com | *Making a difference, together*



# Community Input: Activities in the Comments

sand volleyball rock climbing golf bowling  
shuffleboard large skatepark community garden  
trails roller/ice skating pool (indoor & outdoor)  
splash pad  
outdoor theater archery baseball batting cage  
volleyball (indoor & sand) turf fields stage street  
hockey badminton cornhole farmers market disc golf  
pool table dog park indoor skate park  
indoor walking track futsal workout area (gym)  
softball obstacle course

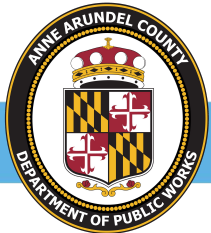

# Preliminary Operational Plan

- Indoor spaces will be completed and opened before outdoor amenities and improvements will be considered.
- Recreational programming for the space is still being finalized.
  - Serve all ages and abilities
  - Would be a mix of drop in opportunities and programmed activities
  - Portions will be available for rent
- Pricing
  - Will be similar to current recreational pricing.
- Hours would be similar to current recreational sites
  - M-F 8:30 Am to 9 PM
  - Saturday 8:30 AM to 7PM
  - Sunday 8 AM to 4PM



# Proposed Edgewater Rec. Center Layout- 30% Design

- 8 Pickleball Courts
- Basketball Court
- 8400 sf Playground
- 3 Activity Rooms
- 2 Party Rooms
- 1300 sf Multi-Purpose Room
- 2 Meeting Rooms
- Open Concept Lobby w/ Seating

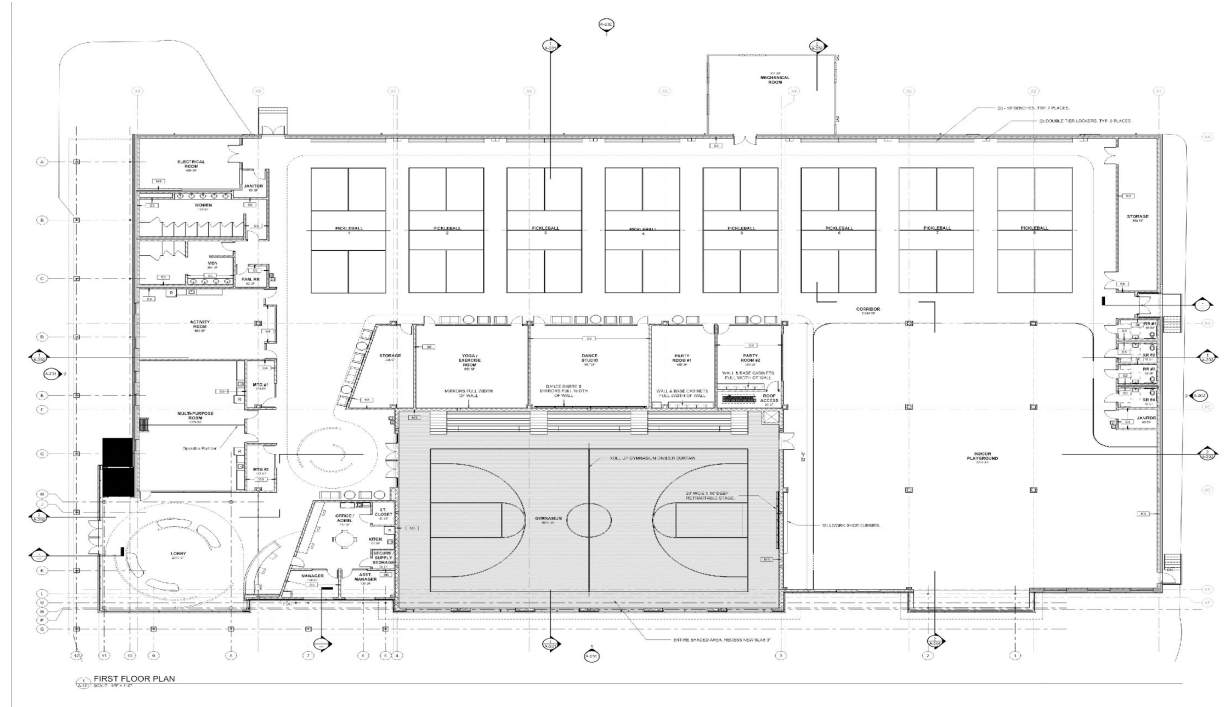

# Proposed Site Layout - 30% Design

- 276 Available Parking Spaces
  - ADA accessibility
    - 12 handicap parking spaces
    - 4 van accessible
    - access aisles
- Perimeter Landscaping
- New parking lot lighting

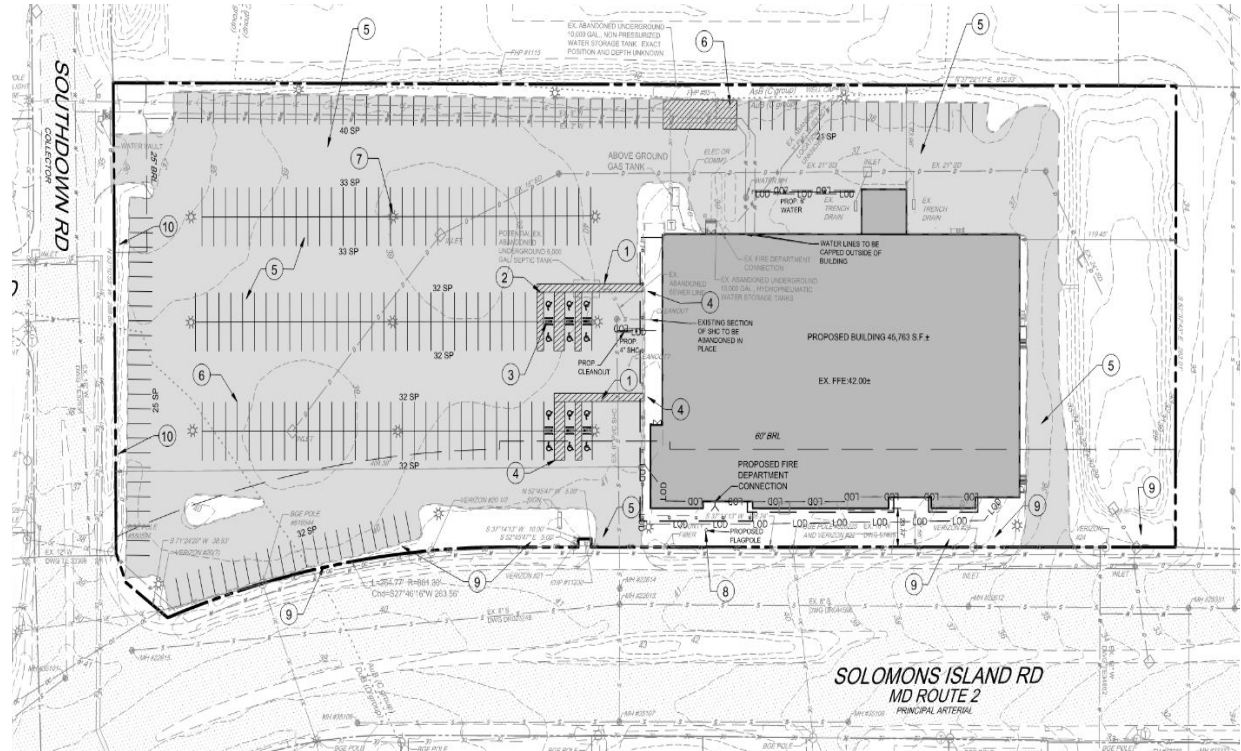

# Project Status

- Schematic Design – Fall 2024
- 30% Public Meeting – January 2025
- Submit Design Development - Spring 2025
- Submit Permits - Summer 2025
- Submit Construction/Bid Documents Packages - Fall/Winter 2025
- Construction Start – Winter/Spring 2026

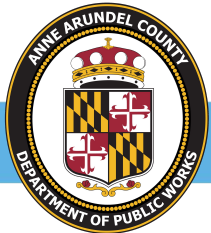

# Questions?

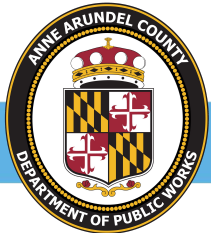

DPWandYOU.com | *Making a difference, together*





# Comment Period

- The public comment period will last 2 weeks and close on **Friday January 24, 2024 at 5pm.**
- Comments can be submitted to Kyle Autry, DPW Project Manager
  - Email: [pwautr19@aacounty.org](mailto:pwautr19@aacounty.org)

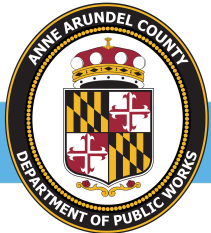

DPWandYOU.com | *Making a difference, together*





## Bureau of Utility Operations

### 24-Hour Emergency

**Water Service:** (410) 222-8400

**Billing Inquiries:** (410) 222-1144



## Bureau of Engineering

**General Inquiries:** (410) 222-7500



## Bureau of Waste Management Services

### Bulk Trash Service / Curbside

**Collections:** (410) 222-6100



## Bureau of Watershed Protection and Restoration

**General Inquiries:** (410) 222-1072



## Bureau of Highways

**General Inquiries:** (410) 222-7321

**Snow Line:** (410) 222-4040

**Email:** [hwyscustomercare@aacounty.org](mailto:hwyscustomercare@aacounty.org)

## Customer Relations:

(410) 222-7582



DPWandYOU.com | *Making a difference, together*

