



Anne Arundel County

Office of Transportation



Office of Transportation Functions



Transportation Planning

(Transit, Bicycle, Pedestrian, MicroMobility, Roadway, Transit Oriented Development (TOD), Long Range, Short Range, Area, and Corridor Studies)



Transit Operations

(Fixed Route, Microtransit on demand, and Elderly/Paratransit)



Capital Projects

(Roadways, Pedestrian, Bicycle, Transit, Facilities, and other transportation related infrastructure)



Grant Management

(Federal, State, Local and private grant management/ implementation)



Innovation

TRANSPORTATION PLANNING

- ▶ MOVE ANNE ARUNDEL! (Transportation Functional Master Plan)
- ▶ WALK & ROLL ANNE ARUNDEL! (Bicycle and Pedestrian Master Plan)
- ▶ Vision Zero (Strategic Highway Safety Plan)
- ▶ Transit Development Plan (5-Year Strategic Transit Plan)
- ▶ Corridor Studies (i.e. BWI-Columbia Corridor)
- ▶ Central Maryland Regional Transportation Plan (CMRTP)
- ▶ State Transit Plan (Led by MDOT-MTA)
- ▶ State Freight Plan (Led by MDOT-MTA)
- ▶ Regional Plans (Targeted Areas within the county)
- ▶ Area Plans (Targeted Areas within the county)
- ▶ Transit Oriented Development Toolbox (Guidelines for Best Practices for TODs)
- ▶ Transportation Improvement Program (TIP)
- ▶ Capital Improvement Program (CIP)
- ▶ Impact Fee Study
- ▶ ZEB Transition Plan Draft (Zero Emissions Bus Transition Plan)
- ▶ Safe Routes to School Study

Bus Network Growth

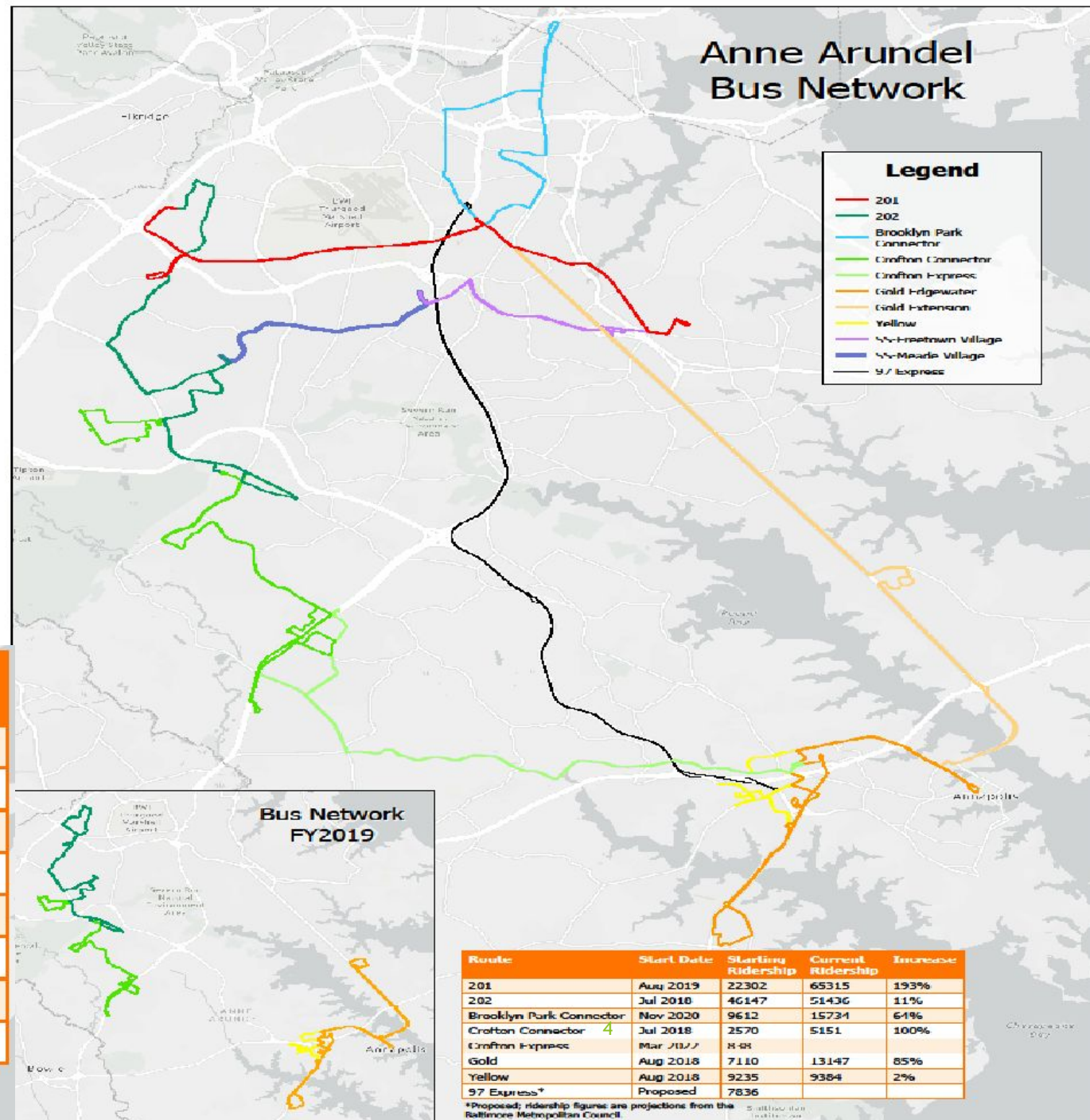

Route	Start Date	Starting Ridership	Current Ridership	Increase
201	Aug 2019	22302	65315	193%
202	Jul 2018	46147	51436	11%
Brooklyn Park Connector	Nov 2020	9612	15734	64%
Crofton Connector	Jul 2018	2570	5151	100%
Crofton Express	Mar 2022	838		
Gold	Aug 2018	7110	13147	85%
Yellow	Aug 2018	9235	9384	2%
97 Express*	Proposed	7836		

*Proposed; ridership figures are projections from the Baltimore Metropolitan Council.

Anne Arundel Microtransit Zones Estimated Ridership

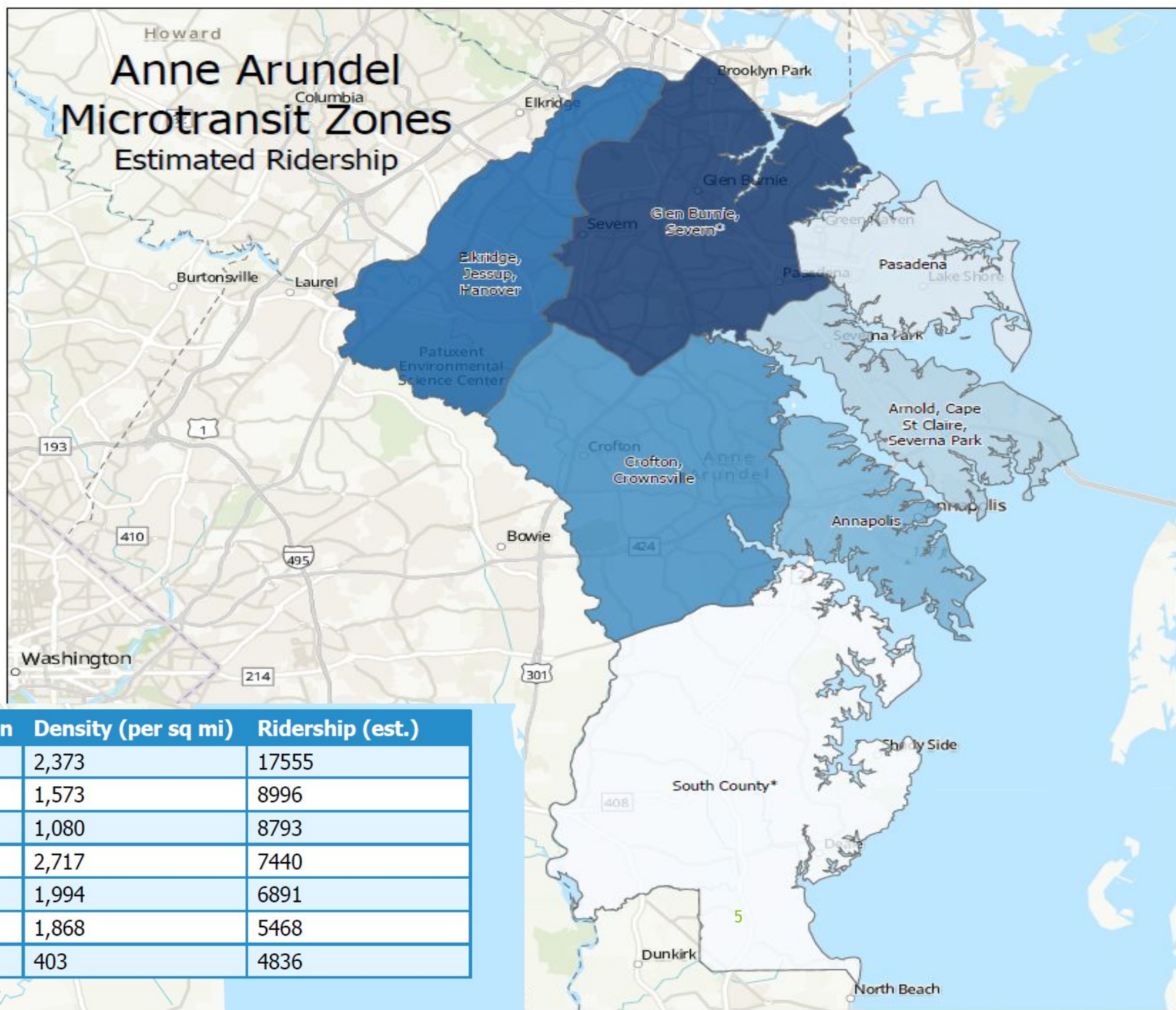

Zone Name	Area (sq mi)	Population	Density (per sq mi)	Ridership (est.)
Glen Burnie, Severn*	72.8	172,738	2,373	17555
Elkridge, Jessup, Hanover	56.3	88,522	1,573	8996
Crofton, Crownsville	80.1	86,525	1,080	8793
Annapolis	26.9	73,214	2,717	7440
Arnold, Cape St Claire, Severna Park	34	67,811	1,994	6891
Pasadena	28.8	53,810	1,868	5468
South County*	118	47,585	403	4836

*Zone is currently in operation.

Technology App's

- ▶ Transit Royal
- ▶ Pingo
- ▶ Passio
- ▶ Google Maps
- ▶ Free Wifi



C565500 - Odenton MARC TOD Dev Ph 1 and 2A

Increased costs to reflect design work and revenues to show receipt of federal earmark

Budget: \$35,600,000 (TIF & Earmark)



C589200 - Transportation Ops Facility

Scope: This project would provide funding acquire the property, design and construct a Transportation Operations (Ops) Facility that would securely house the County's transit fleet along with providing for operations and maintenance staff.

Budget: \$6,978,000

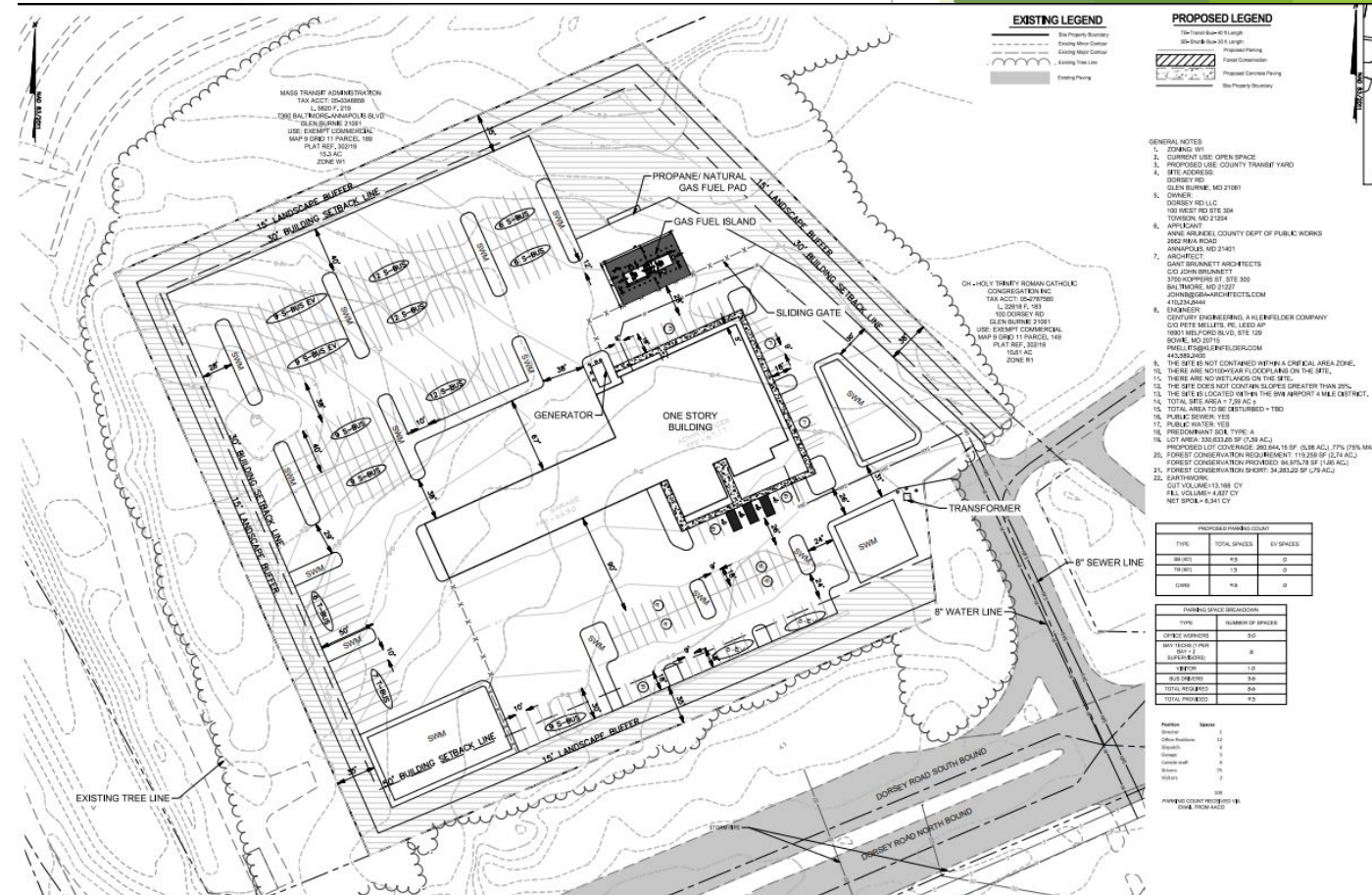

H508400 - Sidewalk/Bikeway Fund

Priority	Location	Request	Est Cost	Cumulative Est Cost
1	Valley Road	Sidewalk on the south side between Knollwood Drive and Wayward Drive	\$460,000	\$460,000
2	BWI/Nursery Spur Trail	Design of Trail Extension from W Maple Road to Nursery Road Light Rail Station	\$997,000	\$1,457,000
3	BWI to Odenton SUP Gaps	Design of shared use path on Milestone Pkwy (Clark to MD 175) and Bluewater Blvd (Portland Station Lane to MD 175)	\$859,000	\$2,316,000
4	Stevenson Road Sidewalk	Design of sidewalk along Stevenson Road from New Cut Rd to Crest Hill Drive	\$260,000	\$2,576,000
5	Grover Road Sidewalk	Design of sidewalk along Grover Road to access Old Mill West High	\$221,000	\$2,797,000
6	North Patuxent Road	Sidewalk on west side filling in missing gap between	\$440,000	\$3,237,000
7	Jacobs Rd	Sidewalk from Town Center Blvd to Pioneer Drive increase access to Severn Center	\$810,000	\$4,047,000

H539600 - Trans Facility Planning

Priority	Location	Request	Est Cost	Cumulative Est Cost
1	Safe Routes to School	Review of existing conditions and recommended improvements for 17 elementary schools in the County	\$341,000	\$341,000
2	Brooklyn Park Mobility Audit	Multimodal planning study for the Brooklyn Park area	\$194,000	\$535,000
3	Forest Drive	Safety Study of Forest Drive from Bywater Road to Bay Ridge Road	\$226,000	\$761,000
4	EV Bus & Facility Planning	A study of how a transition to electric vehicle fleet will impact necessary capital infrastructure and operations activities.	\$249,000	\$1,010,000
5	Riva Town Center Blvd	Feasibility study of an extension of Riva Town Center Blvd over MD 665 to Spruill Rd	\$150,000	\$1,160,000
6	Benfield Blvd	Corridor Study from Veterans Highway to MD 2 (including Evergreen Rd)	\$200,000	\$1,360,000
7	Glen Burnie Town Center	Multimodal planning study for the Glen Burnie Town Center	\$150,000	\$1,510,000
8	Old Mill West Middle School Access Study	School Access Study focused on Stevenson due to new construction of Old Mill Middle School to serve new high school, would include access to Quarterfield Elem	\$200,000	\$1,710,000

H563700 - Ped Improvement - SHA

Priority	Location	Request	Est Cost	Cumulative Est Cost
1	MD 214 - MD 2 to MD 253	Sidewalk on north side to help serve South River High School	\$462,000	\$462,000
2	MD 173 - Duval Hwy to Kenton Dr	Sidewalk on west side between Riviera Beach Library and Sunset Park	\$1,030,000	\$1,492,000
3	MD 168 - Hammonds Ferry Rd to Nursery Rd Light Rail Station	Sidewalk along one or both sides of MD 168 between Hammonds Ferry Road and the Nursery Road Light Rail Station	\$1,180,000	\$2,672,000
4	MD 2 - Ordinance Rd to Walton Ave	Sidewalk on both sides of Richie Hwy connecting Brooklyn Park and Glen Burnie	TBD	\$2,672,000
5	New Cut Road	Design for sidewalk on New Cut Road to help serve Old Mill West High School	\$186,000	\$2,858,000
6	Reece Road/MD 174	Design for sidewalk between Meade Heights Elementary/Town Center Blvd Extension and Severn Center/Van Bokkelen Elementary/Pioneer Drive	\$172,000	\$3,030,000
7	MD 2 - Cypress Creek to McKinsey Rd	Sidewalk on the east side of Ritchie Highway between Cypress Creek and McKinsey Roads	\$1,070,000	\$4,100,000
8	MD 450 - Generals Highway to MD 2	Sidewalk repair to ADA standard and fill in missing gaps along West Street between Generals Highway and Route 2.	TBD	\$4,100,000
9	MD 2 - Tarragon Lane to Forest Dr	Sidewalk construction along MD 2 between Gingerville and Parole	\$620,000	\$4,720,000

H589800 - Ridge Rd Improvements

Scope: This project will provide design plans and recommend phasing of improvements to construct the recommended cross section of Ridge Road between New Ridge Road and Furnace Avenue. An updated feasibility study to evaluate the needs of the corridor and expand the limits of the previous study between New Ridge Road and Dorsey Road (H545901) to include the segment from Dorsey Road to Furnace Ave is currently underway (H545911).

Budget: \$10,786,000

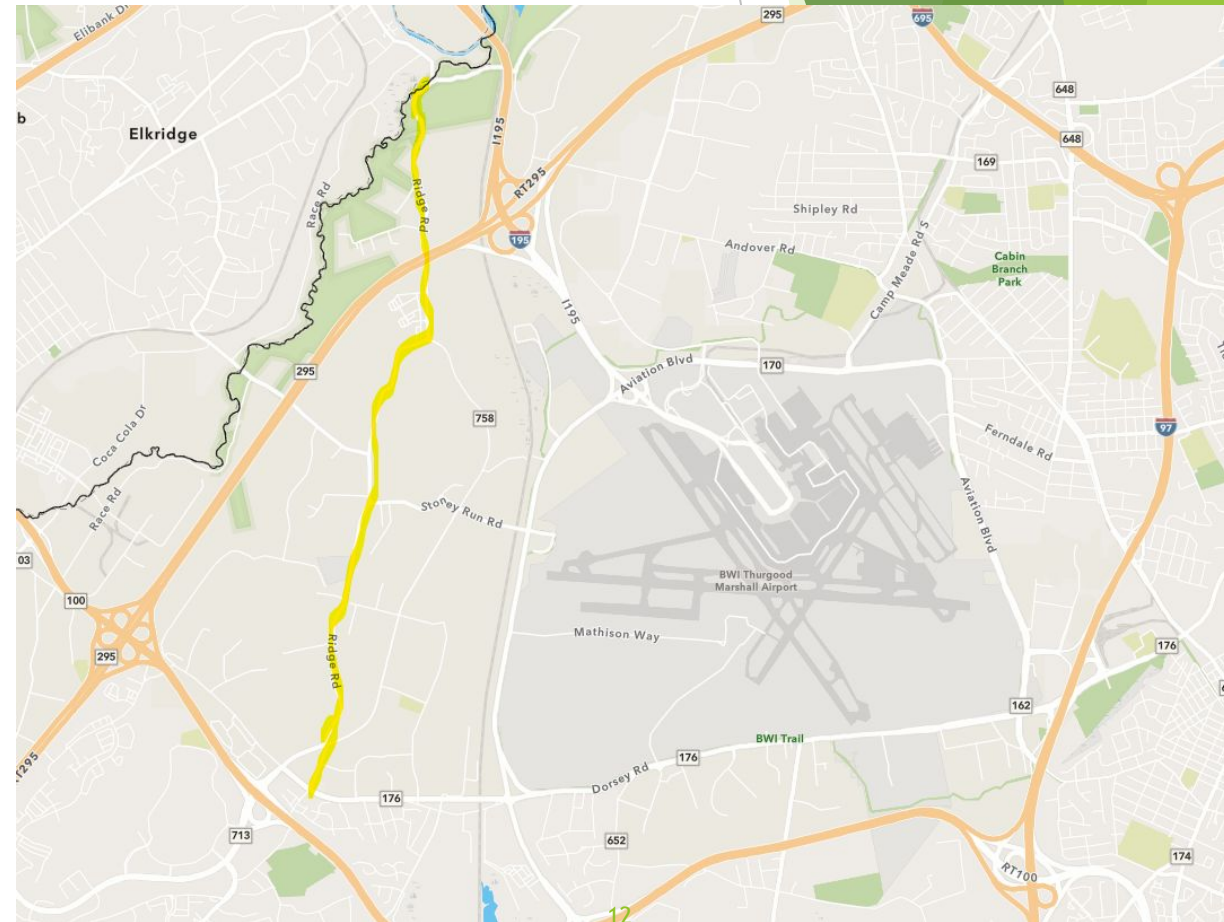

H590400 - Riva Rd Shared Use Path

Scope: This project will provide a shared use path along Riva Road from Speicher Drive to Forest Drive, with improvements at the crossing locations of Riva Road along the path. Additional work will include extension of the shared use path to West Street and burial of utilities in identified areas.

Budget: \$2,514,000

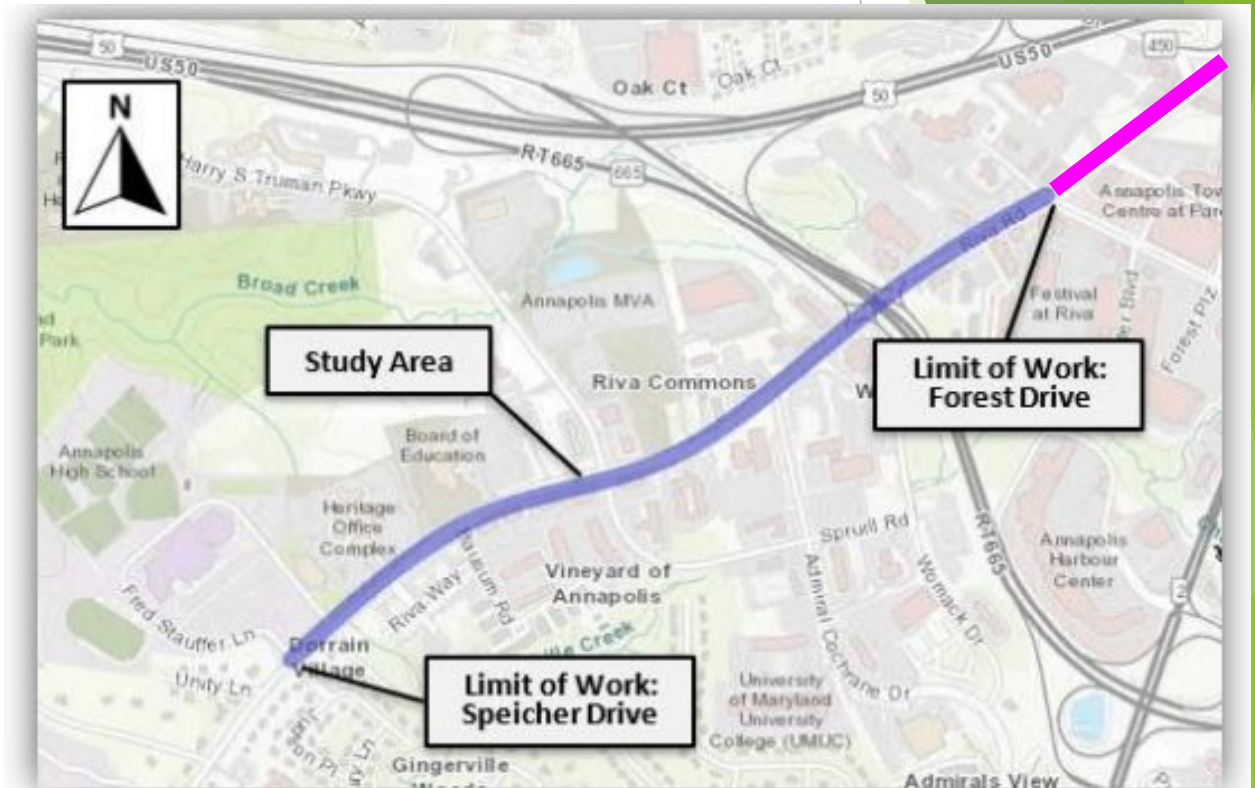

Figure 1: Study Area Map

H590500 - BWI Trail Extension & Baybrook Connector

Scope: This project will provide for the extension of the BWI Trail from the current terminus at Maple Road to the Nursery Road Light Rail Station, and extend the existing shared use path on Belle Grove Road up to Route 2. This project will be completed in phases.

Phase I - Maple Road to Nursery Road Light Rail Station

Phase II - Nursery Road Light Rail Station to Route 2 along Belle Grove Road

Budget: \$21,521,000

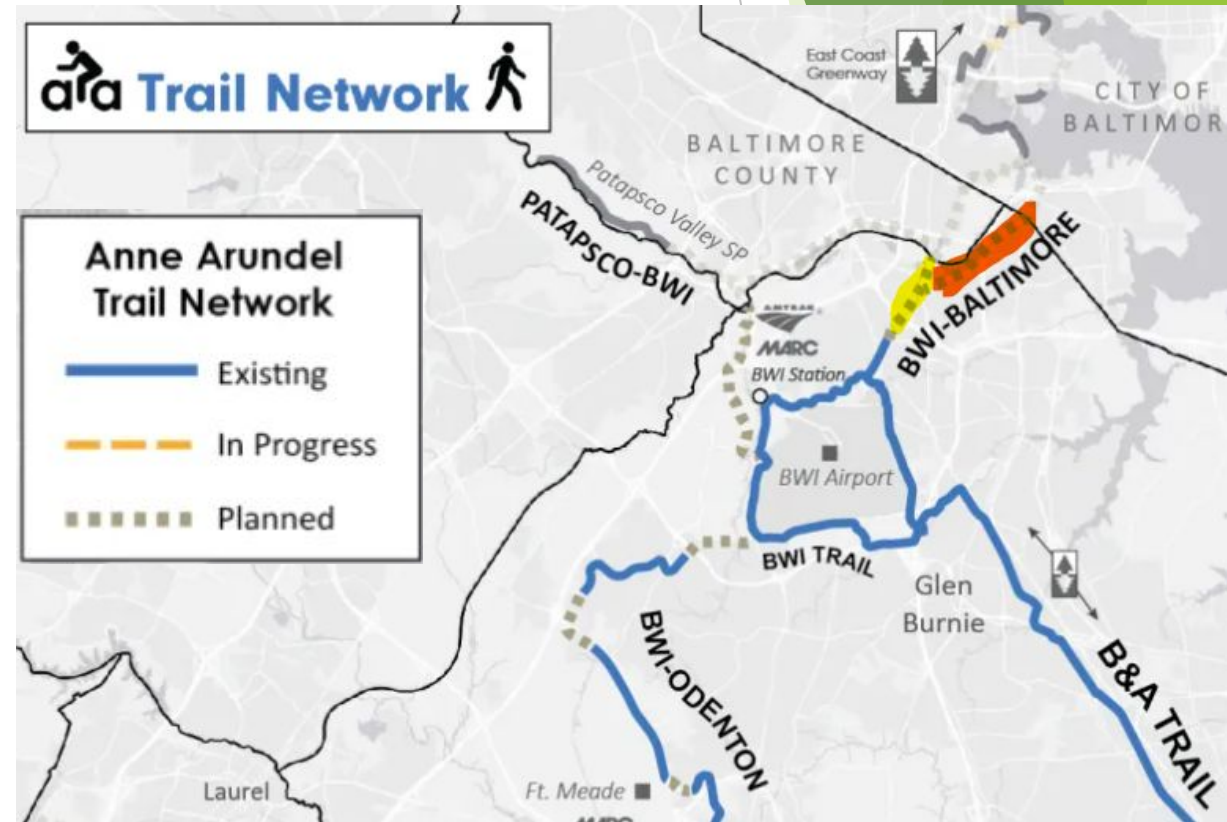

H590600 - Safe Routes to Transit

Scope: This project will improve access to transit stops through bicycle and pedestrian facility upgrades with a focus on providing access to stop locations without ADA access, and improving roadway crossing safety in the location of transit stops

Budget: \$500,000/year

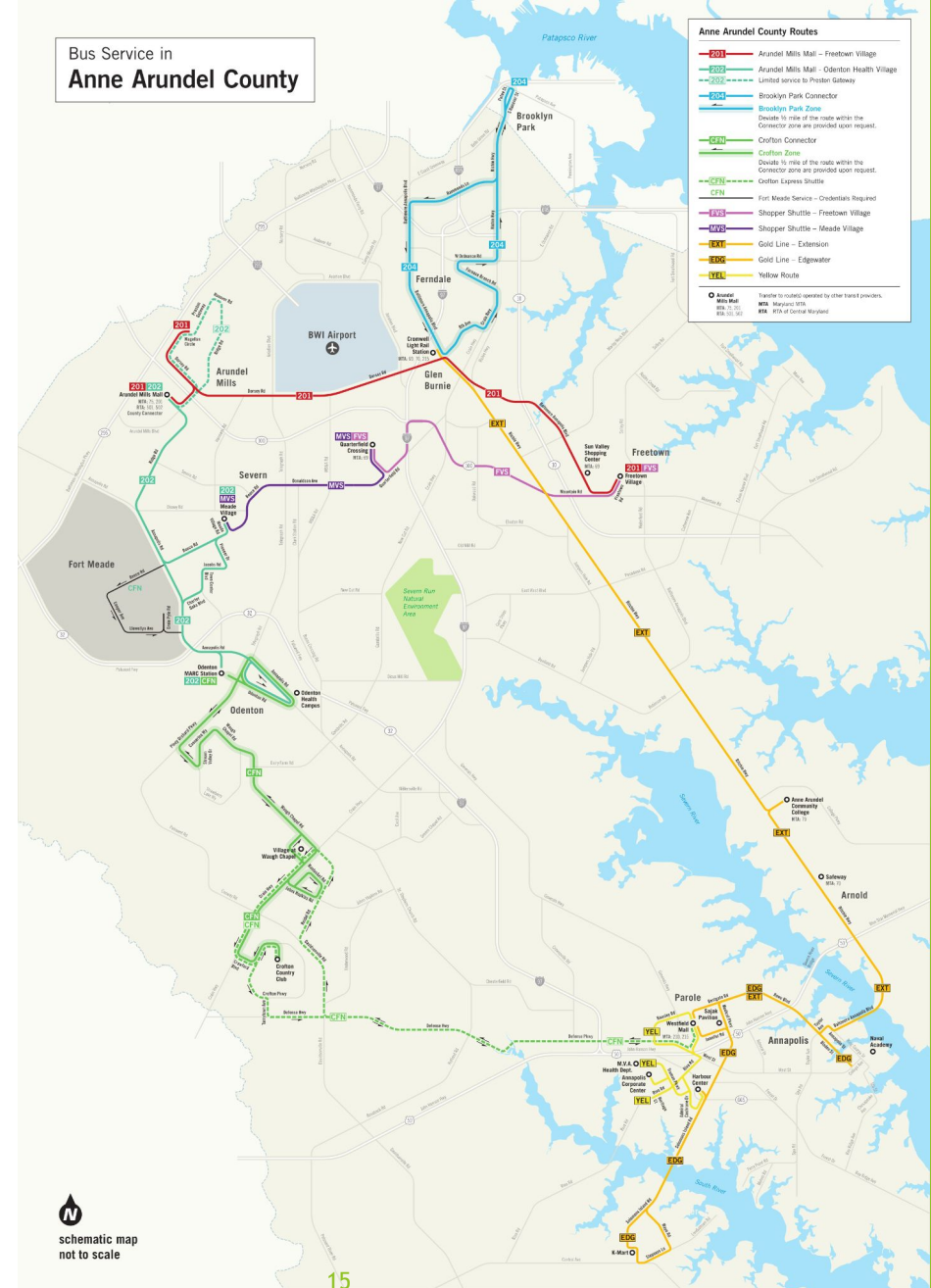

Thank you!