

SECTION VIII
TRAFFIC CONTROL





TABLE OF CONTENTS

TRAFFIC CONTROL

<u>No.</u>	<u>Title</u>
TC-1	Local Roadway – Typical Shoulder Work Site
TC-2	Local Roadway – Typical Lane Closure
TC-3	Typical Pedestrian Control
TC-4	Two Lane Roadway – Typical Shoulder Work Site
TC-5	Two Lane Roadway – Typical Lane Closure
TC-6	Major Two Lane Roadway – Typical Shoulder Work Site
TC-7	Major Two Lane Roadway – Typical Lane Closure
TC-8	Major Two Lane Roadway – Typical Bypass Detour
TC-9	Undivided Highway – Typical Right Lane Closure
TC-10	Undivided Highway – Typical Left Lane Closure
TC-11	Undivided Highway – Typical Partial Closure
TC-12	Undivided Highway – Typical Moving Lane Closure
TC-13	Divided Highway – Typical Lane Closure
TC-14	Divided Highway – Typical Moving Lane Closure
TC-15	Divided Highway – Typical Roadway Closure
TC-16	Minor Intersection – Typical Roadway Closure
TC-17	Intersection – Typical Right Lane Closure
TC-18	Intersection – Typical Left Lane Closure
TC-19	Intersection – Typical Partial Closure
TC-20	Typical Closure
TC-21	Temporary Street Name Sign

1. WARNING LIGHTS SHOULD BE USED TO MARK CHANNELIZING DEVICES AT NIGHT AS NEEDED.
2. CHANNELIZING DEVICES ARE TO BE EXTENDED TO A POINT WHERE THEY ARE VISIBLE TO APPROACHING TRAFFIC.

KEY :

-  CHANNELIZING DEVICES
-  SIGN SUPPORT
-  FACE OF SIGN
-  DIRECTION OF TRAFFIC
-  WORK SITE

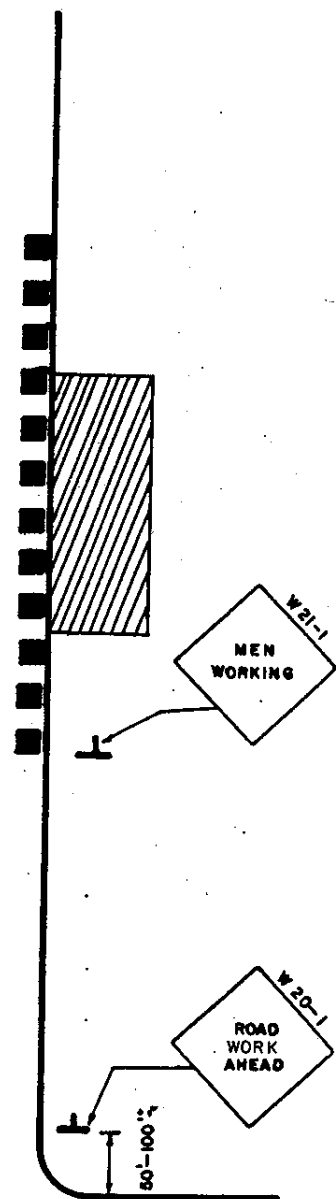
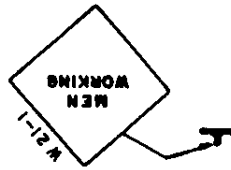

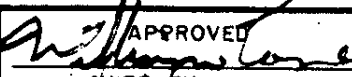





ANNE ARUNDEL COUNTY DEPARTMENT OF PUBLIC WORKS	APPROVED  CHIEF ENGINEER	STANDARD TRAFFIC CONTROL DETAILS LOCAL ROADWAY - TYPICAL SHOULDER WORK SITE	REVISED 9-97 <i>RB</i>	TC 1
	DESIGN ENGINEER 9/17/88			
	DATE			

GENERAL NOTES:

1. FLOOD LIGHTS SHOULD BE PROVIDED TO MARK FLAGGER STATIONS AT NIGHT AS NEEDED.
2. IF ENTIRE WORK AREA IS VISIBLE FROM ONE STATION, A SINGLE FLAGGER MAY BE USED.
3. WARNING LIGHTS SHOULD BE USED TO MARK CHANNELIZING DEVICES AT NIGHT AS NEEDED.
4. CHANNELIZING DEVICES ARE TO BE EXTENDED TO A POINT WHERE THEY ARE VISIBLE TO APPROACHING TRAFFIC.

KEY:

-  CHANNELIZING DEVICES
-  SIGN SUPPORT
-  FACE OF SIGN
-  DIRECTION OF TRAFFIC
-  FLAGGER
-  WORK SITE

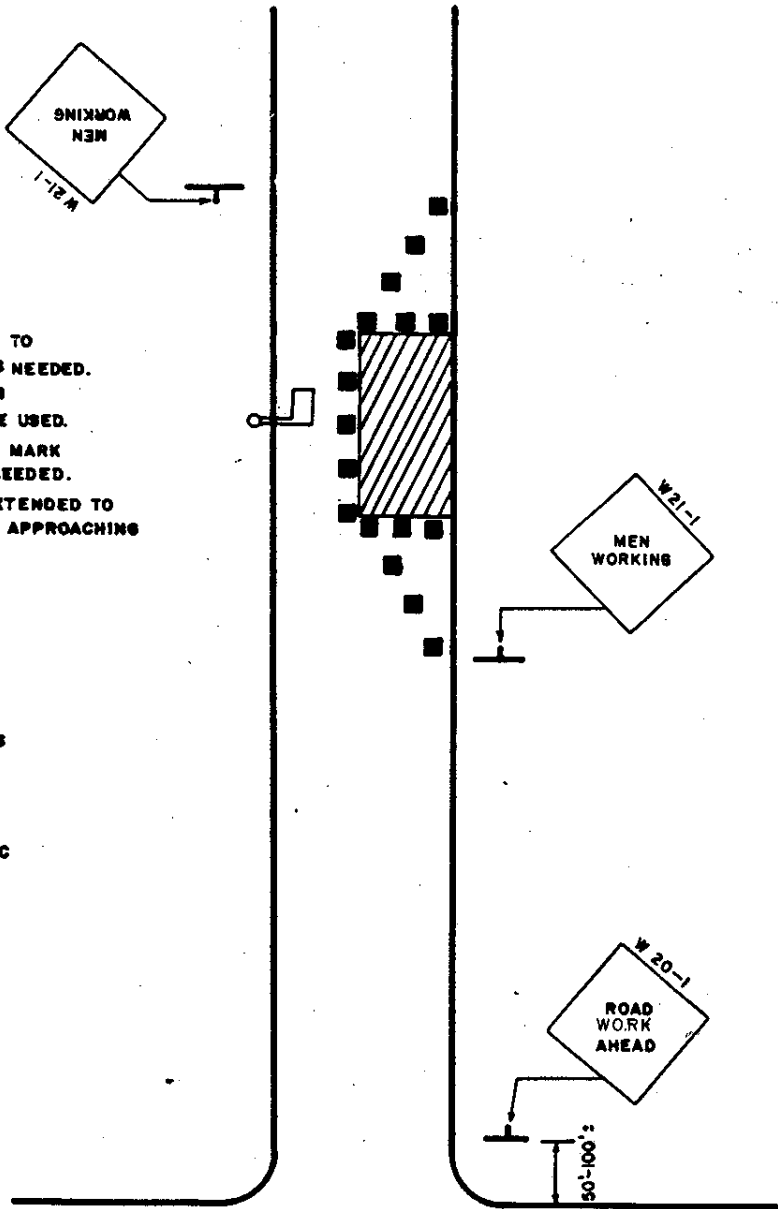

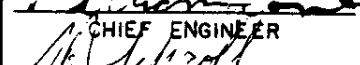

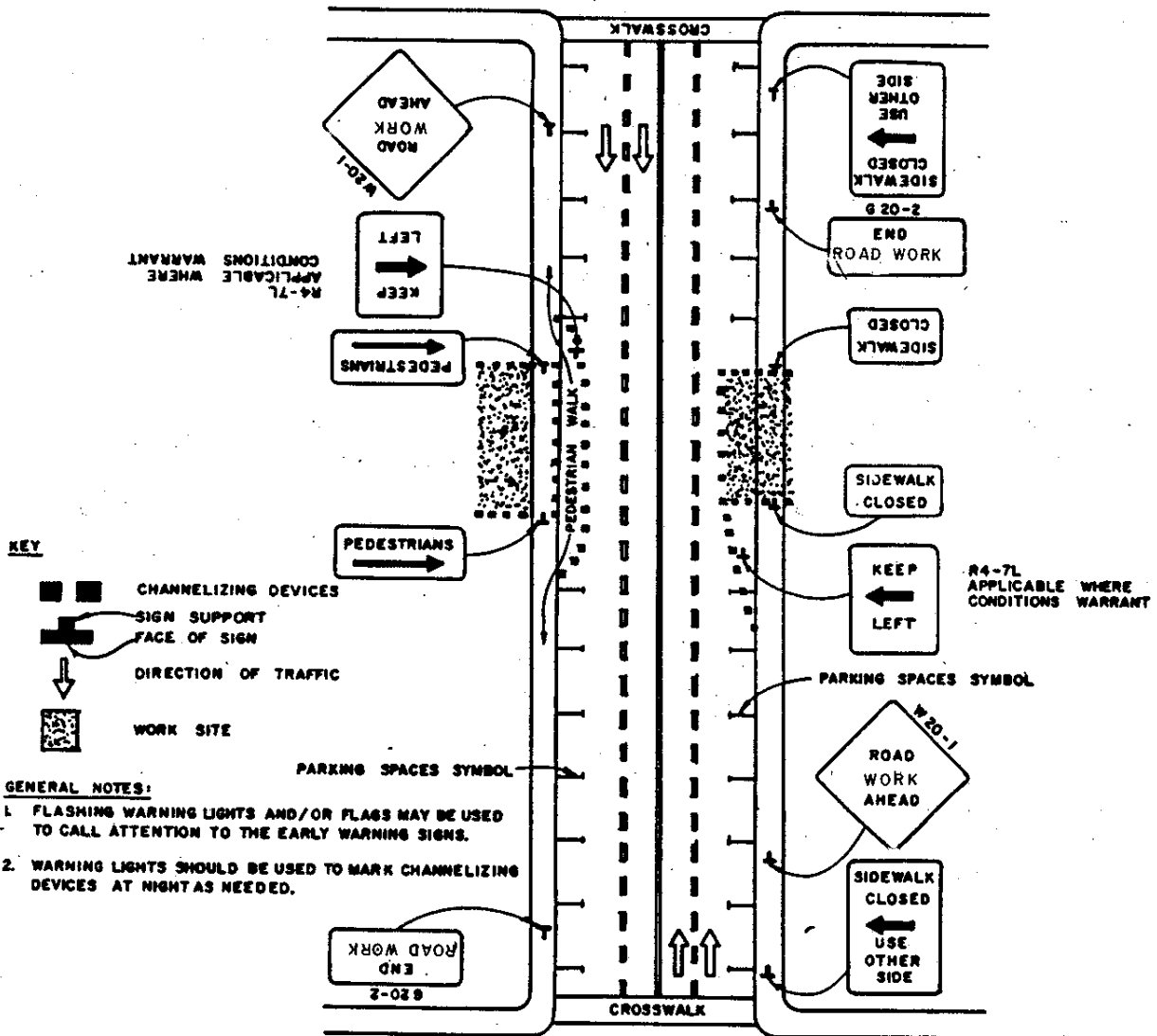

ANNE ARUNDEL COUNTY DEPARTMENT OF PUBLIC WORKS	APPROVED  CHIEF ENGINEER	STANDARD TRAFFIC CONTROL DETAILS LOCAL ROADWAY - TYPICAL LANE CLOSURE	REVISED 9-97 <i>RB</i>	TC 2
	 DESIGN ENGINEER 9/17/97		_____	
	DATE		_____	
	_____		_____	
	_____		_____	





ANNE ARUNDEL COUNTY DEPARTMENT OF PUBLIC WORKS	APPROVED <i>[Signature]</i> CHIEF ENGINEER	STANDARD TRAFFIC CONTROL DETAILS TYPICAL PEDESTRIAN CONTROL	REVISED 9-97 <i>AB</i>	TC 3
	DESIGN ENGINEER 9/7/98 DATE		_____	
	_____		_____	
	_____		_____	

GENERAL NOTES:

1. FLASHING WARNING LIGHTS AND/OR FLAGS MAY BE USED TO CALL ATTENTION TO THE EARLY WARNING SIGNS.
2. WARNING LIGHTS SHOULD BE USED TO MARK CHANNELIZING DEVICES AT NIGHT AS NEEDED.

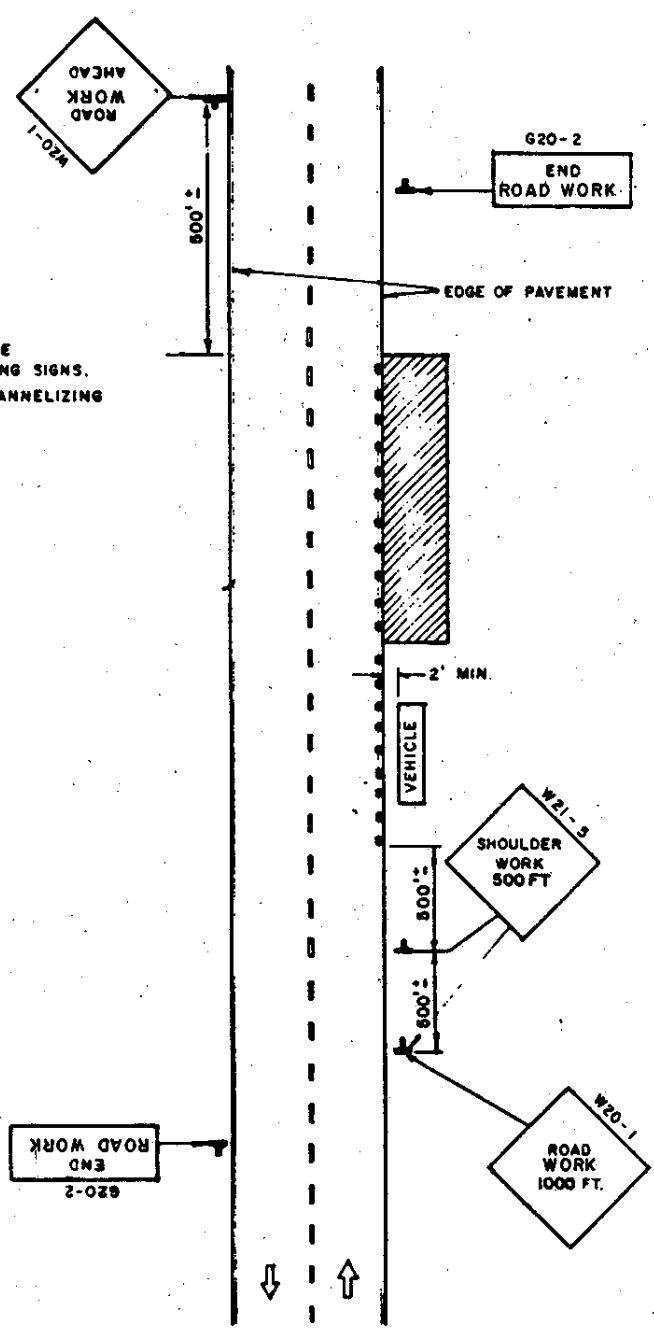
- KEY:**
-  CHANNELIZING DEVICES
 -  SIGN SUPPORT
FACE OF SIGN
 -  DIRECTION OF TRAFFIC
 -  WORK SITE



ANNE ARUNDEL COUNTY DEPARTMENT OF PUBLIC WORKS	APPROVED  CHIEF ENGINEER	STANDARD TRAFFIC CONTROL DETAILS TWO LANE ROADWAY - TYPICAL SHOULDER WORK SITE	REVISED 9 - 97 <i>RB</i>	TC 4
	 DESIGN ENGINEER			
	9/17/98 DATE			

NOTE: WARNING SIGN SEQUENCE IN OPPOSITE DIRECTION SAME AS BELOW.

CHANNELIZING DEVICES SEPARATE WORK AREA FROM TRAVELED WAY

200' TO 300' ±







W 20-2
ROAD END
ROAD WORK

W 20-2
END
ROAD WORK

GENERAL NOTES:

1. FLOOD LIGHTS SHOULD BE PROVIDED TO MARK FLAGGER STATIONS AT NIGHT AS NEEDED.
2. IF ENTIRE WORK AREA IS VISIBLE FROM ONE STATION, A SINGLE FLAGGER MAY BE USED.
3. WARNING LIGHTS SHOULD BE USED TO MARK CHANNELIZING DEVICES AT NIGHT AS NEEDED.
4. CHANNELIZING DEVICES ARE TO BE EXTENDED TO A POINT WHERE THEY ARE VISIBLE TO APPROACHING TRAFFIC.

KEY:



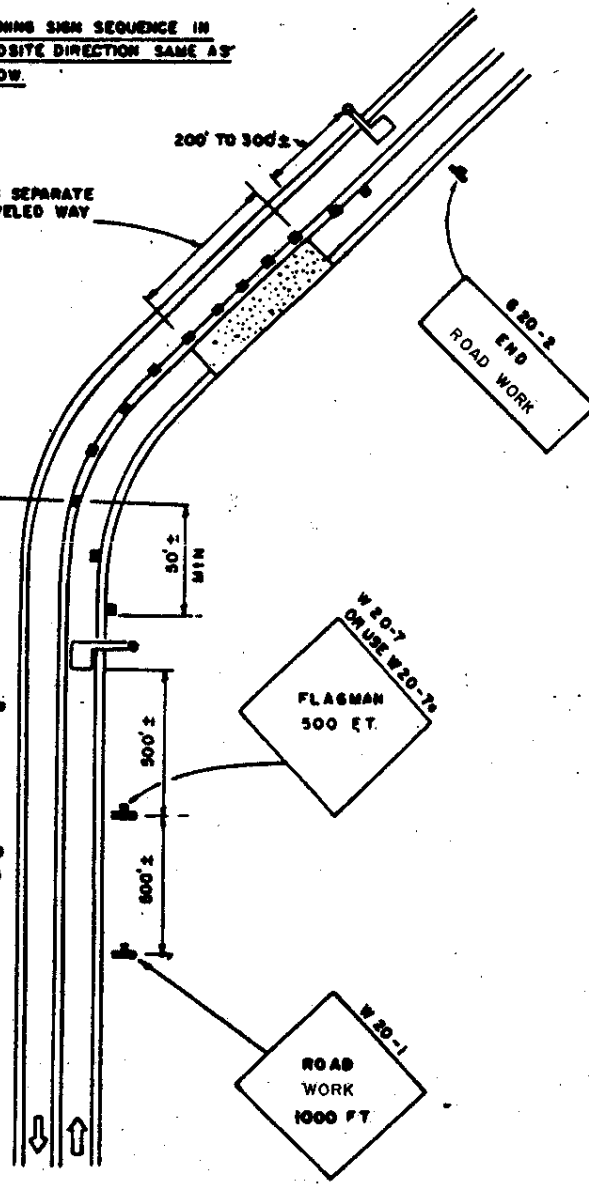

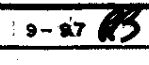
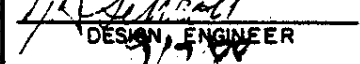
-  CHANNELIZING DEVICES
-  SIGN SUPPORT
-  FACE OF SIGN
-  DIRECTION OF TRAFFIC
-  FLAGGER
-  WORK SITE



ANNE ARUNDEL COUNTY DEPARTMENT OF PUBLIC WORKS	APPROVED  CHIEF ENGINEER	STANDARD TRAFFIC CONTROL DETAILS TWO LANE ROADWAY - TYPICAL LANE CLOSURE	REVISED 9-87 	TC 5
	DESIGN ENGINEER  DATE		_____	
	_____		_____	
	_____		_____	
	_____		_____	

GENERAL NOTES:

1. FLASHING WARNING LIGHTS AND/OR FLAGS MAY BE USED TO CALL ATTENTION TO THE EARLY WARNING SIGNS.
2. WARNING LIGHTS SHOULD BE USED TO MARK CHANNELIZING DEVICES AT NIGHT AS NEEDED.

- KEY:**
-  CHANNELIZING DEVICES
 -  SIGN SUPPORT
 -  FACE OF SIGN
 -  DIRECTION OF TRAFFIC
 -  WORK SITE

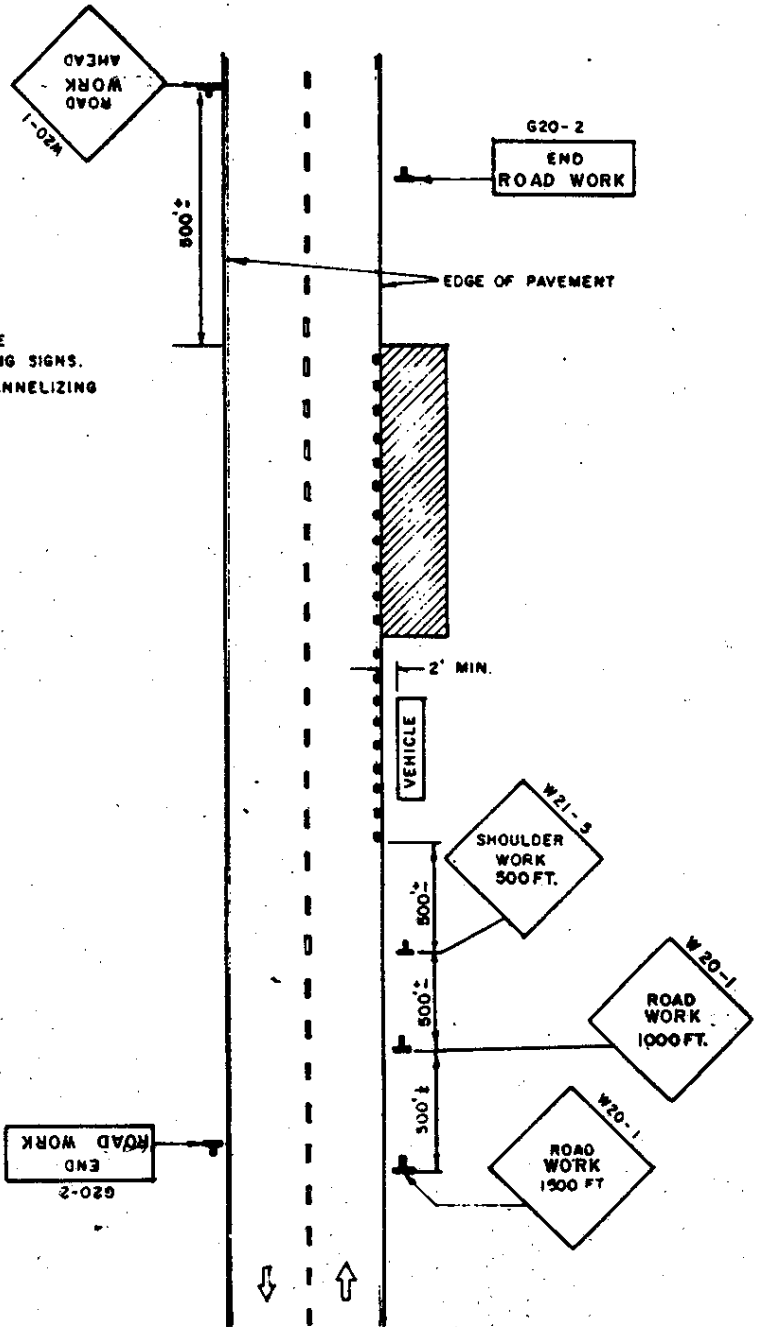

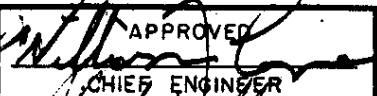
ANNE ARUNDEL COUNTY DEPARTMENT OF PUBLIC WORKS	APPROVED  CHIEF ENGINEER	STANDARD TRAFFIC CONTROL DETAILS MAJOR TWO LANE ROADWAY - TYPICAL SHOULDER WORK SITE	REVISED 9-97 <i>AB</i>	TC 6
	DESIGN ENGINEER 9/9/88 DATE		_____ _____ _____	

NOTE: WARNING SIGN SEQUENCE IN OPPOSITE DIRECTION SAME AS BELOW.

CHANNELIZING DEVICES SEPARATE WORK AREA FROM TRAVELED WAY

200' TO 300' ±







620-2
ROAD END
ROAD WORK

620-2
ROAD END
ROAD WORK

GENERAL NOTES:

1. FLOOD LIGHTS SHOULD BE PROVIDED TO MARK FLAGGER STATIONS AT NIGHT AS NEEDED.
2. IF ENTIRE WORK AREA IS VISIBLE FROM ONE STATION, A SINGLE FLAGGER MAY BE USED.
3. WARNING LIGHTS SHOULD BE USED TO MARK CHANNELIZING DEVICES AT NIGHT AS NEEDED.
4. CHANNELIZING DEVICES ARE TO BE EXTENDED TO A POINT WHERE THEY ARE VISIBLE TO APPROACHING TRAFFIC.

KEY:

-  CHANNELIZING DEVICES
-  SIGN SUPPORT
-  FACE OF SIGN
-  DIRECTION OF TRAFFIC
-  FLAGGER
-  WORK SITE

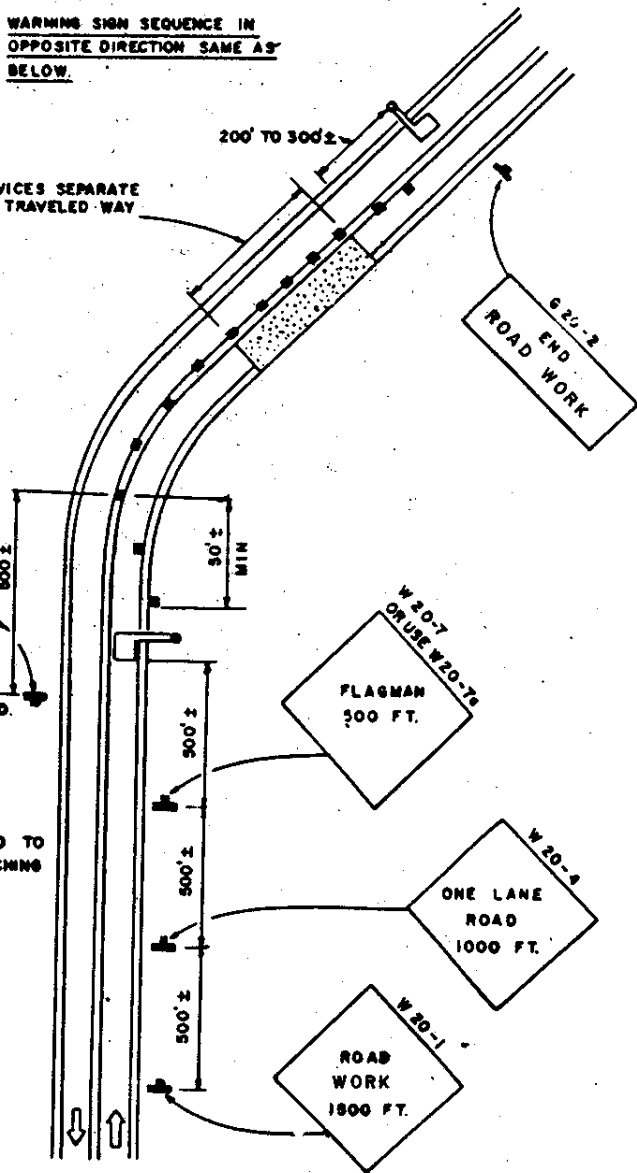

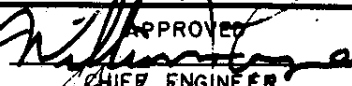
APPROVED

 ANNE ARUNDEL COUNTY
 DEPARTMENT OF PUBLIC WORKS
 CHIEF ENGINEER
 DESIGN ENGINEER
 9/7/88
 DATE

STANDARD
 TRAFFIC CONTROL DETAILS
 MAJOR TWO LANE ROADWAY
 TYPICAL LANE CLOSURE

REVISED	TC 7
9-97 RB	

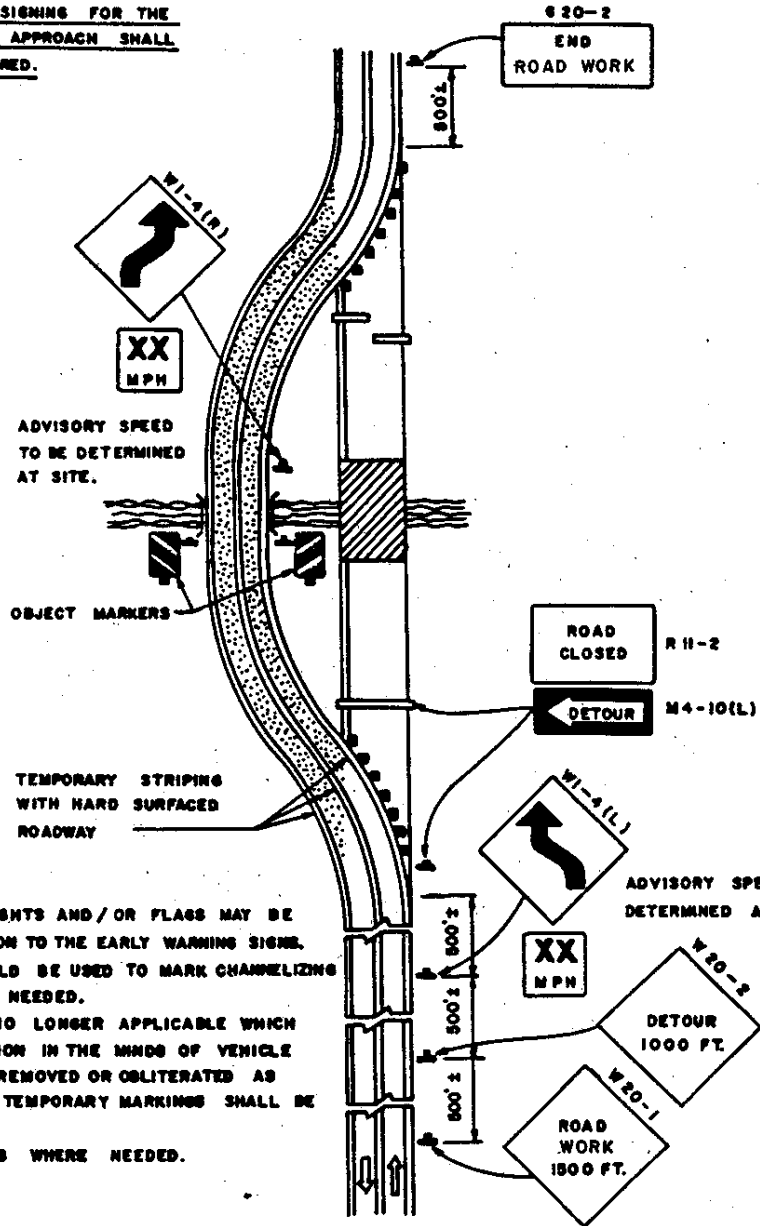
NOTE: SIMILAR SIGNING FOR THE OPPOSITE APPROACH SHALL BE REQUIRED.



GENERAL NOTES:

1. FLASHING WARNING LIGHTS AND/OR FLASS MAY BE USED TO CALL ATTENTION TO THE EARLY WARNING SIGNS.
2. WARNING LIGHTS SHOULD BE USED TO MARK CHANNELIZING DEVICES AT NIGHT AS NEEDED.
3. PAVEMENT MARKINGS NO LONGER APPLICABLE WHICH MIGHT CREATE CONFUSION IN THE MINDS OF VEHICLE OPERATORS SHALL BE REMOVED OR OBLITERATED AS SOON AS PRACTICABLE, TEMPORARY MARKINGS SHALL BE USED AS NECESSARY.
4. DELINEATORS ON BYPASS WHERE NEEDED.

- KEY:**
- CHANNELIZING DEVICES
 - SIGN SUPPORT
 - FACE OF SIGN
 - DIRECTION OF TRAFFIC
 - TYPE III BARRICADE
 - WORK SITE

ANNE ARUNDEL COUNTY DEPARTMENT OF PUBLIC WORKS	APPROVED CHIEF ENGINEER	STANDARD TRAFFIC CONTROL DETAILS MAJOR TWO LANE ROADWAY - TYPICAL BYPASS DETOUR	REVISED 9-97 <i>RB</i>	TC 8
	DESIGN ENGINEER 9/2/96 CATE		_____	
	_____		_____	
	_____		_____	

GENERAL NOTES:

1. TAPER FORMULA:

$L = S \cdot W$ FOR SPEEDS OF 45 OR MORE

$L = \frac{WS^2}{60}$ FOR SPEEDS OF 40 OR LESS

WHERE:

L = MINIMUM LENGTH OF TAPER

S = NUMERICAL VALUE OF POSTED SPEED LIMIT
PRIOR TO WORK OR 85 PERCENTILE SPEED.

W = WIDTH OF OFFSET

2. THE MAXIMUM SPACING BETWEEN CHANNELIZING DEVICES IN A TAPER SHOULD BE APPROXIMATELY EQUAL IN FEET TO THE SPEED LIMIT.





3. FLASHING WARNING LIGHTS AND/OR FLAGS MAY BE USED TO CALL ATTENTION TO THE EARLY WARNING SIGNS.

4. FLOOD LIGHTS SHOULD BE PROVIDED TO MARK FLAGGER STATIONS AT NIGHT AS NEEDED.

5. CHANNELIZING DEVICES ARE TO BE EXTENDED TO A POINT WHERE THEY ARE VISIBLE TO APPROACHING TRAFFIC.

6. WARNING LIGHTS SHOULD BE USED ON CHANNELIZING DEVICES AT NIGHT AS NEEDED.

KEY:

-  CHANNELIZING DEVICES
-  SIGN SUPPORT
-  DIRECTION OF TRAFFIC
-  ARROW PANEL
-  WORK SITE

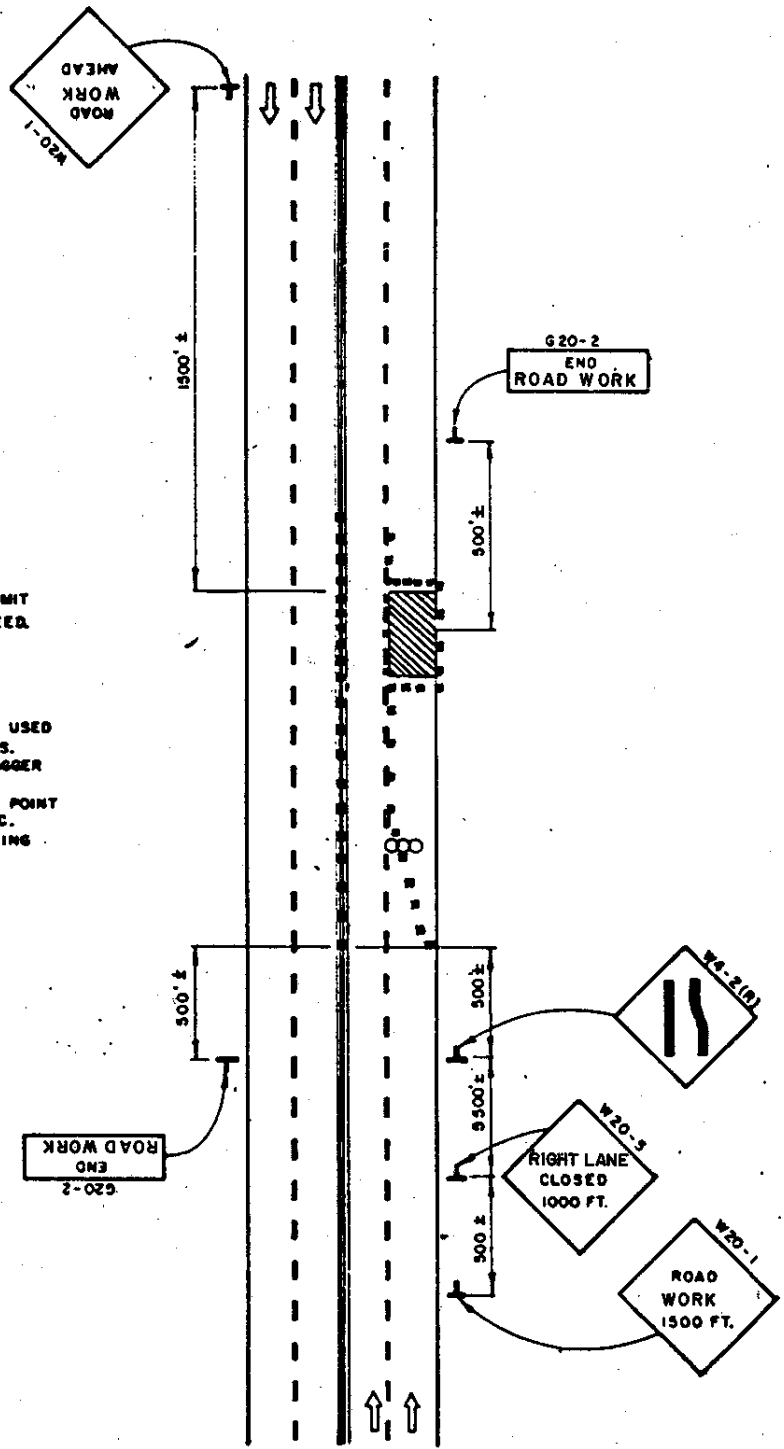

ANNE ARUNDEL COUNTY
DEPARTMENT OF PUBLIC WORKS

APPROVED
[Signature]
CHIEF ENGINEER
DESIGN ENGINEER
9/17/88
DATE

STANDARD TRAFFIC CONTROL DETAILS
UNDIVIDED HIGHWAY-TYPICAL
RIGHT LANE CLOSURE

REVISED	TC
9-97 RB	9

GENERAL NOTES:

1. TAPER FORMULA:

$L = S \cdot W$ FOR SPEEDS OF 45 OR MORE







$L = \frac{WS^2}{80}$ FOR SPEEDS OF 40 OR LESS

WHERE:

- L = MINIMUM LENGTH OF TAPER
- S = NUMERICAL VALUE OF POSTED SPEED LIMIT PRIOR TO WORK OR 85 PERCENTILE SPEED.
- W = WIDTH OF OFFSET

2. THE MAXIMUM SPACING BETWEEN CHANNELIZING DEVICES IN A TAPER SHOULD BE APPROXIMATELY EQUAL IN FEET TO THE SPEED LIMIT.
3. FLASHING WARNING LIGHTS AND/OR FLAGS MAY BE USED TO CALL ATTENTION TO THE EARLY WARNING SIGNS.
4. FLOOD LIGHTS SHOULD BE PROVIDED TO MARK FLAGGER STATIONS AT NIGHT AS NEEDED.
5. CHANNELIZING DEVICES ARE TO BE EXTENDED TO A POINT WHERE THEY ARE VISIBLE TO APPROACHING TRAFFIC.
6. WARNING LIGHTS SHOULD BE USED ON CHANNELIZING DEVICES AT NIGHT AS NEEDED.

KEY:

-  CHANNELIZING DEVICES
-  SIGN SUPPORT
-  FACE OF SIGN
-  DIRECTION OF TRAFFIC
-  ARROW PANEL
-  WORK SITE

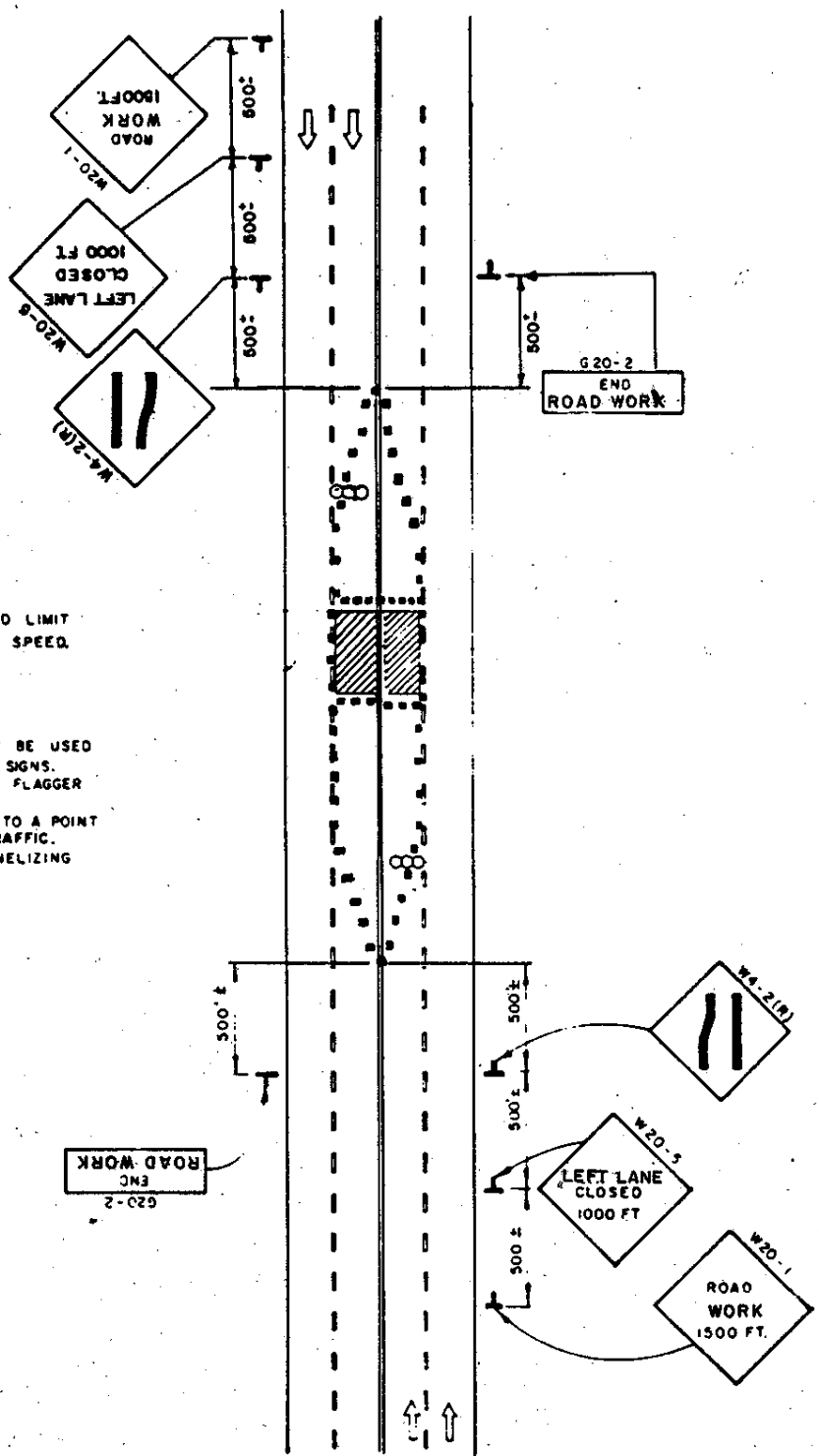

ANNE ARUNDEL COUNTY DEPARTMENT OF PUBLIC WORKS	APPROVED  CHIEF ENGINEER	STANDARD TRAFFIC CONTROL DETAILS UNDIVIDED HIGHWAY - TYPICAL LEFT LANE CLOSURE	REVISED 9-97 <i>RB</i>	TC 10
	DESIGN ENGINEER DATE 9/3/88		_____	
	_____		_____	
	_____		_____	

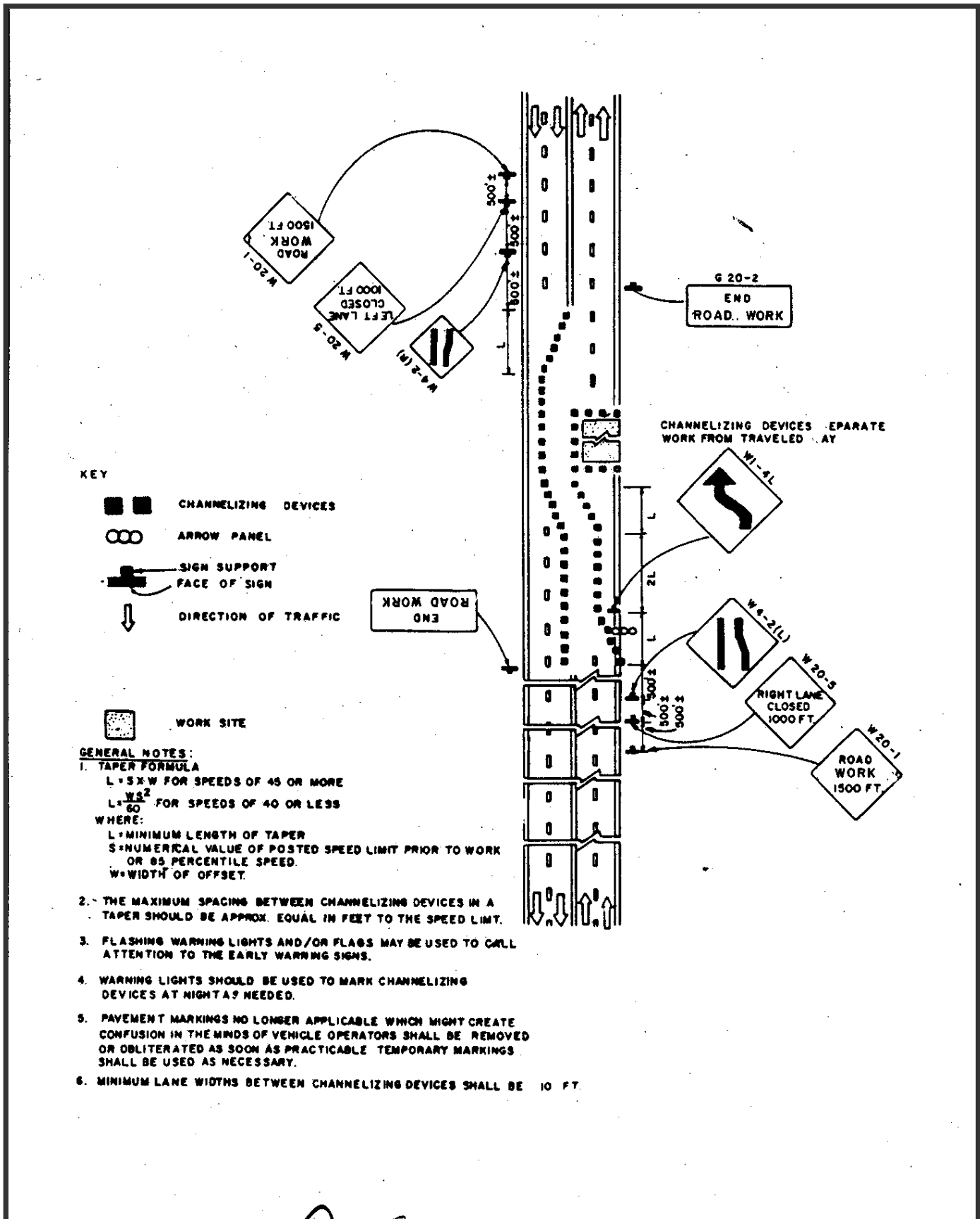

KEY

- CHANNELIZING DEVICES
- ARROW PANEL
- SIGN SUPPORT
- FACE OF SIGN
- DIRECTION OF TRAFFIC

GENERAL NOTES:

1. TAPER FORMULA
 - $L = S \times W$ FOR SPEEDS OF 45 OR MORE
 - $L = \frac{W \times S^2}{40}$ FOR SPEEDS OF 40 OR LESS
 WHERE:
 - L = MINIMUM LENGTH OF TAPER
 - S = NUMERICAL VALUE OF POSTED SPEED LIMIT PRIOR TO WORK OR 85 PERCENTILE SPEED.
 - W = WIDTH OF OFFSET.
2. THE MAXIMUM SPACING BETWEEN CHANNELIZING DEVICES IN A TAPER SHOULD BE APPROX. EQUAL IN FEET TO THE SPEED LIMIT.
3. FLASHING WARNING LIGHTS AND/OR FLAGS MAY BE USED TO CALL ATTENTION TO THE EARLY WARNING SIGNS.
4. WARNING LIGHTS SHOULD BE USED TO MARK CHANNELIZING DEVICES AT NIGHTS AS NEEDED.
5. PAVEMENT MARKINGS NO LONGER APPLICABLE WHICH MIGHT CREATE CONFUSION IN THE MINDS OF VEHICLE OPERATORS SHALL BE REMOVED OR OBLITERATED AS SOON AS PRACTICABLE. TEMPORARY MARKINGS SHALL BE USED AS NECESSARY.
6. MINIMUM LANE WIDTHS BETWEEN CHANNELIZING DEVICES SHALL BE 10 FT.

ANNE ARUNDEL COUNTY DEPARTMENT OF PUBLIC WORKS	APPROVED CHIEF ENGINEER	STANDARD TRAFFIC CONTROL DETAILS UNDIVIDED HIGHWAY - TYPICAL PARTIAL CLOSURE	REVISED 9-97 AB	TC
	DESIGN ENGINEER 9/2/88		II	

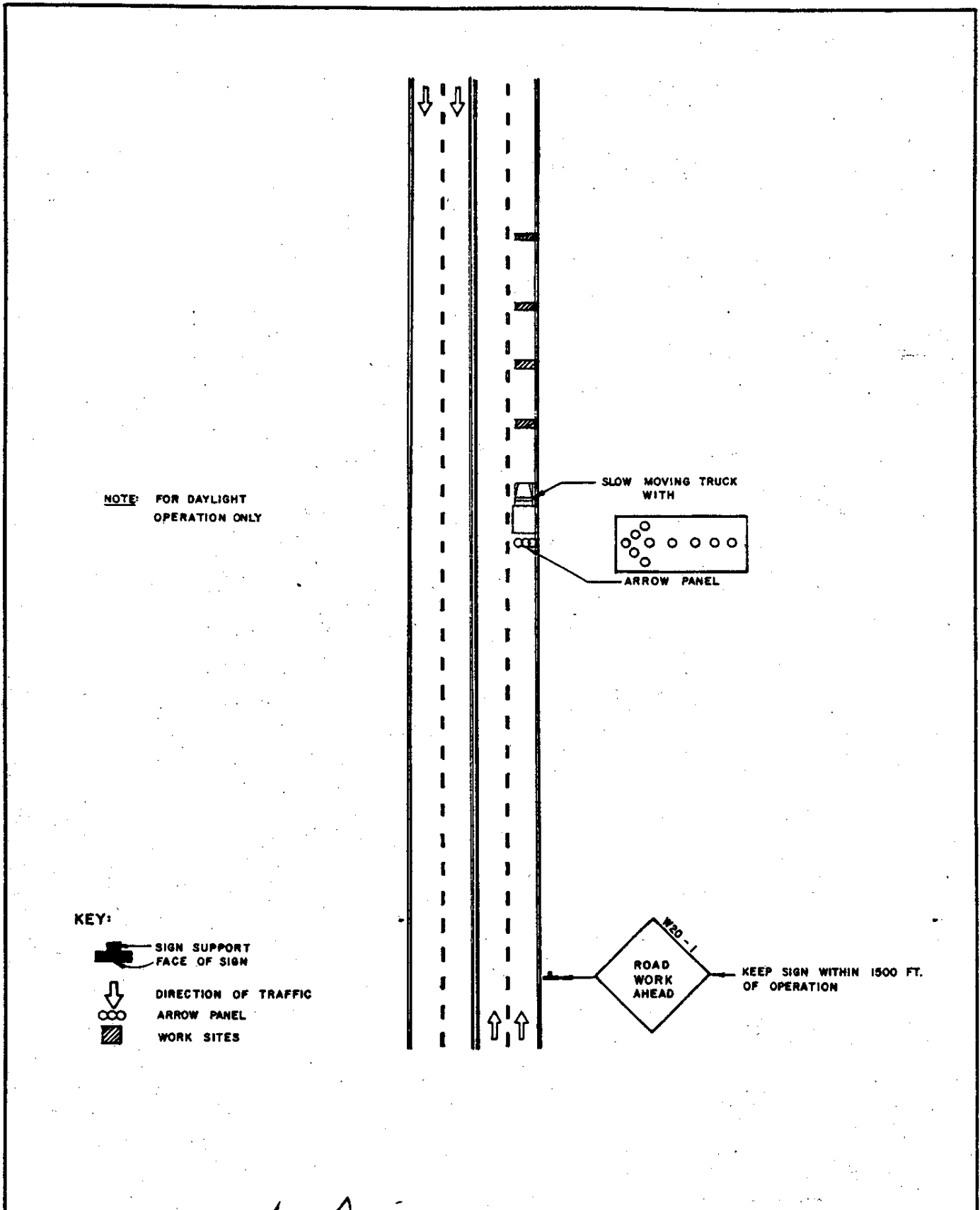

NOTE: FOR DAYLIGHT
OPERATION ONLY

KEY:

-  SIGN SUPPORT
FACE OF SIGN
-  DIRECTION OF TRAFFIC
-  ARROW PANEL
-  WORK SITES

ANNE ARUNDEL COUNTY DEPARTMENT OF PUBLIC WORKS	APPROVED <i>[Signature]</i> CHIEF ENGINEER	STANDARD TRAFFIC CONTROL DETAILS UNDIVIDED HIGHWAY-TYPICAL MOVING LANE CLOSURE	REVISED	TC 12
	DESIGN ENGINEER <i>[Signature]</i> 9/17/88 DATE		9-97 <i>RB</i>	

CASE I
LOW SPEED (≤ 45 MPH.)
LANE CLOSURE

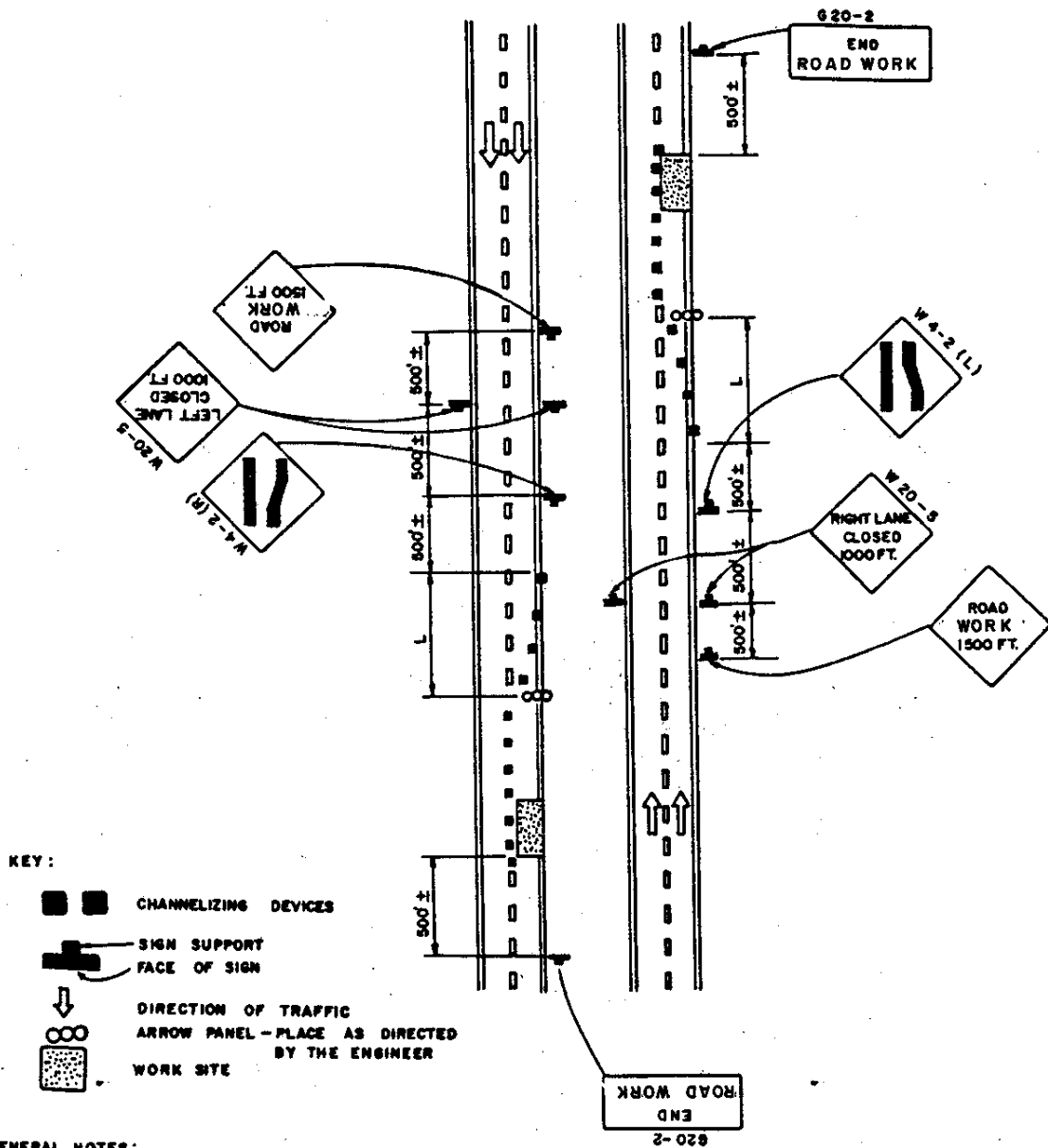

ANNE ARUNDEL COUNTY DEPARTMENT OF PUBLIC WORKS	APPROVED <i>[Signature]</i> CHIEF ENGINEER	STANDARD TRAFFIC CONTROL DETAILS DIVIDED HIGHWAY-TYPICAL LANE CLOSURE	REVISED 8-97 <i>RB</i>	TC	
	DESIGN ENGINEER 9/17/88		DATE	13	
	_____		_____	_____	_____
	_____		_____	_____	_____

GENERAL NOTES:

1. TAPER FORMULA:

$L = S \times W$ FOR SPEEDS OF 45 OR MORE

$L = \frac{WS^2}{60}$ FOR SPEEDS OF 40 OR LESS

WHERE:

L = MINIMUM LENGTH OF TAPER
 S = NUMERICAL VALUE OF POSTED SPEED LIMIT
 PRIOR TO WORK OR 85 PERCENTILE SPEED.

W = WIDTH OF OFFSET





2. THE MAXIMUM SPACING BETWEEN CHANNELIZING DEVICES IN A TAPER SHOULD BE APPROXIMATELY EQUAL IN FEET TO THE SPEED LIMIT.

3. ALL SIGNS SHOWN ARE PORTABLE AND MOVE WITH CONSTRUCTION.

4. ARROW PANEL WILL MOVE WITH CONSTRUCTION.

5. APPROPRIATE SIGNS ARE TO BE USED FOR LEFT LANE CLOSURE.

KEY:

-  CHANNELIZING DEVICES
-  SIGN SUPPORT
FACE OF SIGN
-  DIRECTION OF TRAFFIC
-  ARROW PANEL
-  WORK SITE

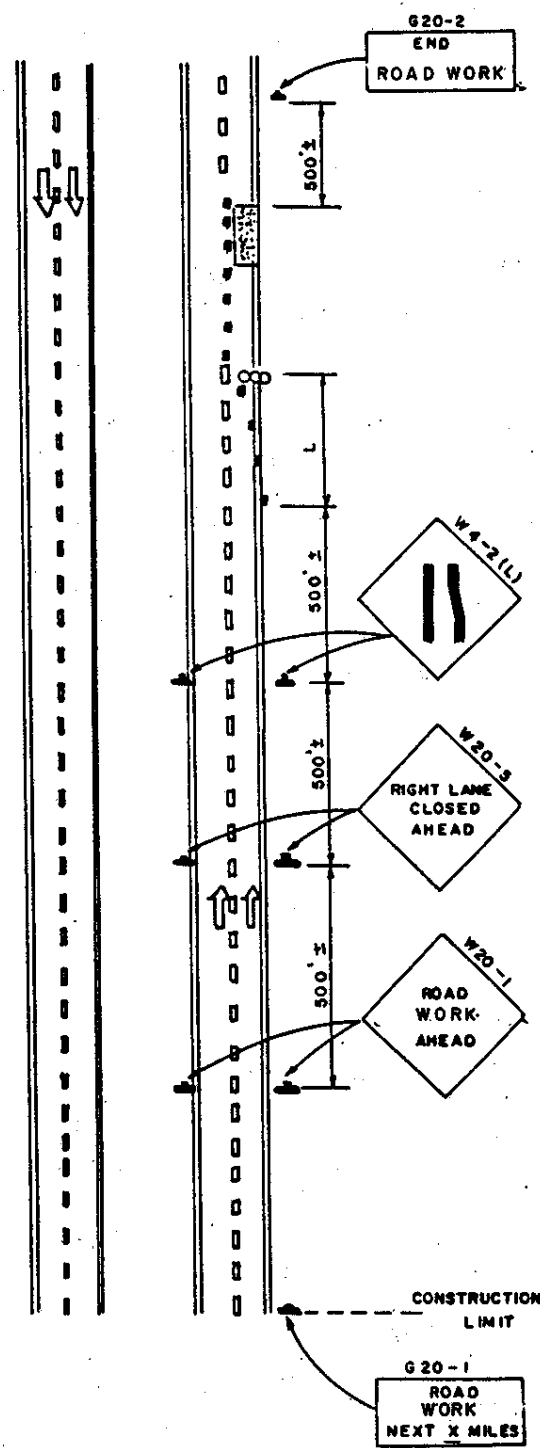

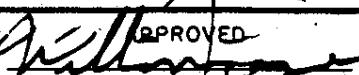
ANNE ARUNDEL COUNTY DEPARTMENT OF PUBLIC WORKS	APPROVED  CHIEF ENGINEER	STANDARD TRAFFIC CONTROL DETAILS DIVIDED HIGHWAY-TYPICAL MOVING LANE CLOSURE	REVISED 9-97 <i>RB</i>	TC <hr/> 14
	DESIGN ENGINEER 9/7/98 DATE		G 20-1 ROAD WORK NEXT X MILES	
	CONSTRUCTION LIMIT		W 20-1 ROAD WORK AHEAD	
	W 20-3 RIGHT LANE CLOSED AHEAD		W 4-2(L)	

NOTE: SIMILAR SIGNING FOR THE OPPOSITE APPROACH SHALL BE REQUIRED.

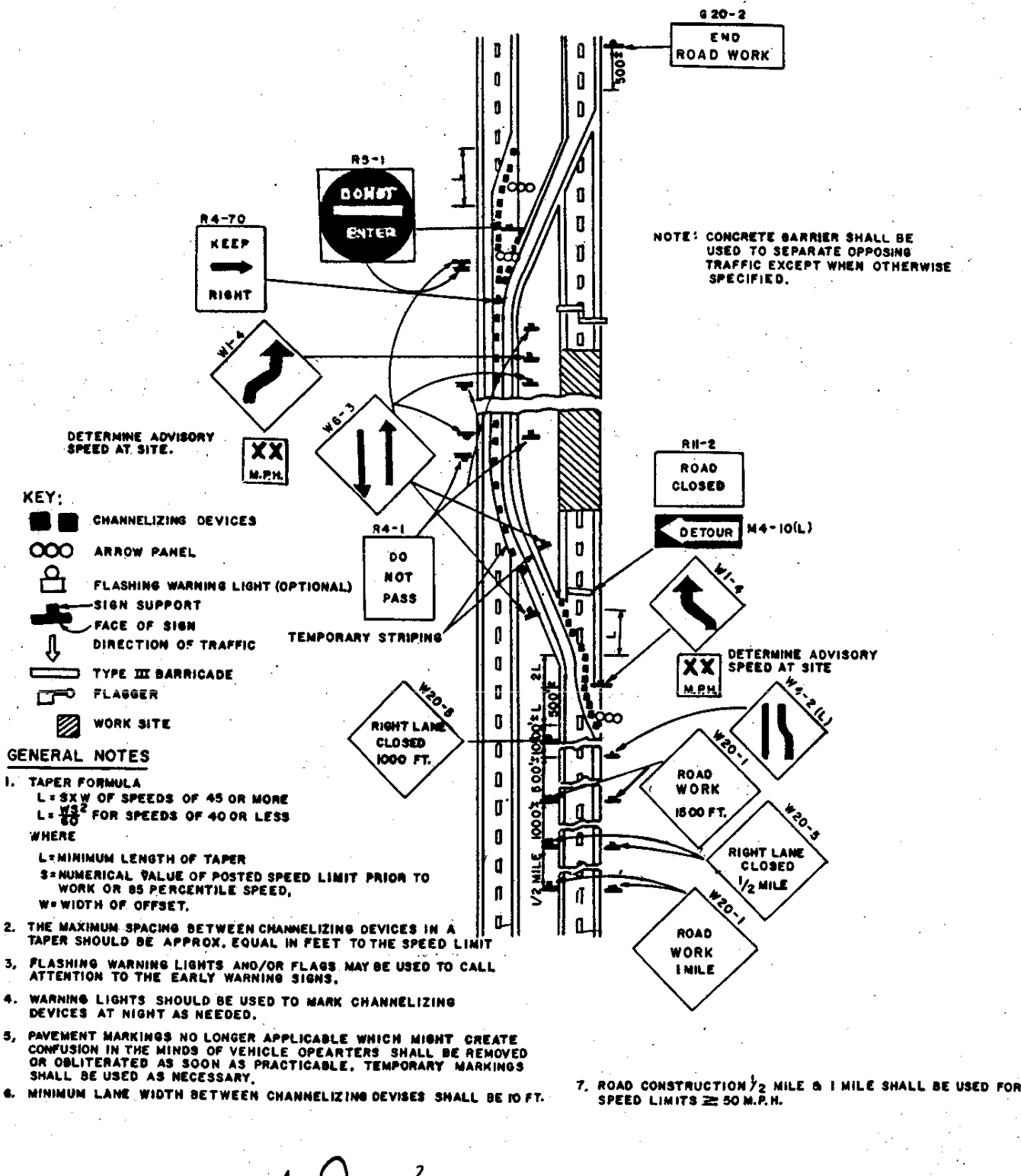

APPROVED: *[Signature]*
 ANNE ARUNDEL COUNTY DEPARTMENT OF PUBLIC WORKS
 CHIEF ENGINEER
 DESIGN ENGINEER
 DATE 9/17/88

STANDARD TRAFFIC CONTROL DETAILS
 DIVIDED HIGHWAY - TYPICAL ROADWAY CLOSURE



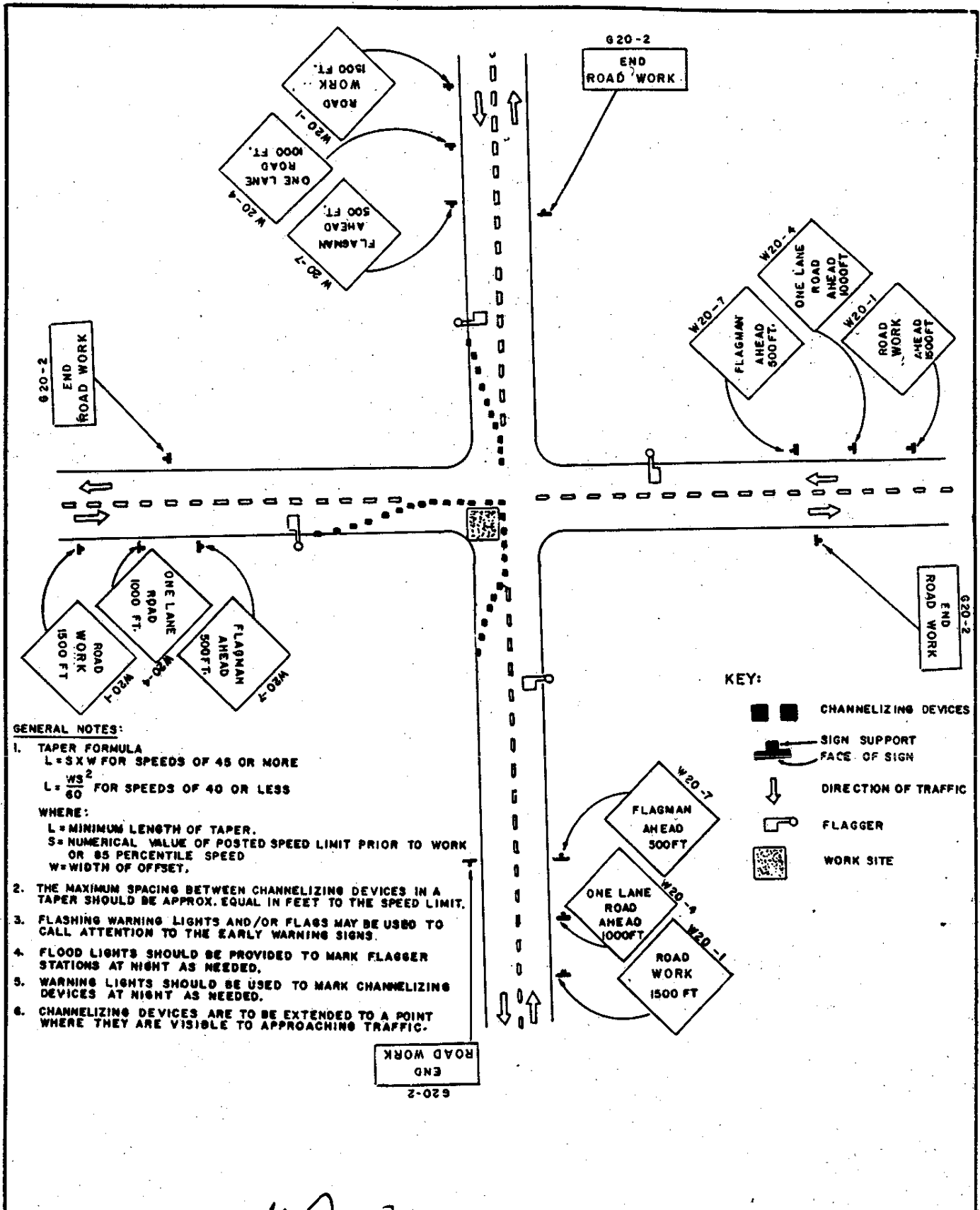

REVISED	TC
.9 - 97 <i>[Signature]</i>	
	15

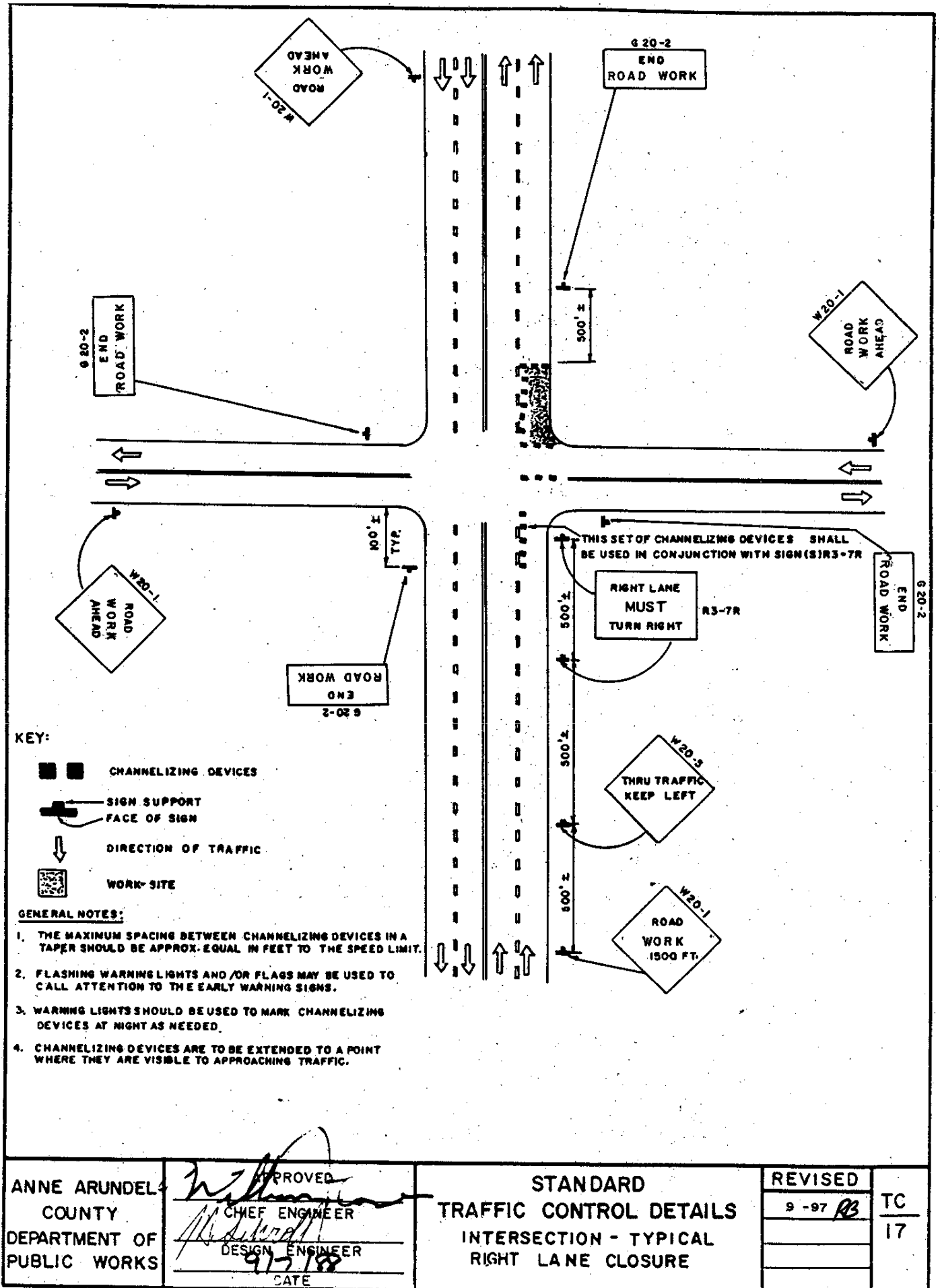

ANNE ARUNDEL COUNTY DEPARTMENT OF PUBLIC WORKS	APPROVED CHIEF ENGINEER	STANDARD TRAFFIC CONTROL DETAILS MINOR INTERSECTION-TYPICAL LANE CLOSURE WITH FLAGGER	REVISED .9 - 97 <i>AB</i>	TC
	DESIGN ENGINEER 9/17/08		DATE	16
	9/17/08		DATE	16
	9/17/08		DATE	16



KEY:

-  CHANNELIZING DEVICES
-  SIGN SUPPORT
-  FACE OF SIGN
-  DIRECTION OF TRAFFIC
-  WORK SITE

GENERAL NOTES:

1. THE MAXIMUM SPACING BETWEEN CHANNELIZING DEVICES IN A TAPER SHOULD BE APPROX. EQUAL IN FEET TO THE SPEED LIMIT.
2. FLASHING WARNING LIGHTS AND/OR FLAGS MAY BE USED TO CALL ATTENTION TO THE EARLY WARNING SIGNS.
3. WARNING LIGHTS SHOULD BE USED TO MARK CHANNELIZING DEVICES AT NIGHT AS NEEDED.
4. CHANNELIZING DEVICES ARE TO BE EXTENDED TO A POINT WHERE THEY ARE VISIBLE TO APPROACHING TRAFFIC.

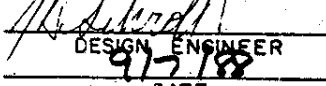
ANNE ARUNDEL COUNTY DEPARTMENT OF PUBLIC WORKS	APPROVED  CHIEF ENGINEER	STANDARD TRAFFIC CONTROL DETAILS INTERSECTION - TYPICAL RIGHT LANE CLOSURE	REVISED 9 - 97 <i>AB</i>	TC 17
	DESIGN ENGINEER  DATE 9/7/88		_____ _____	

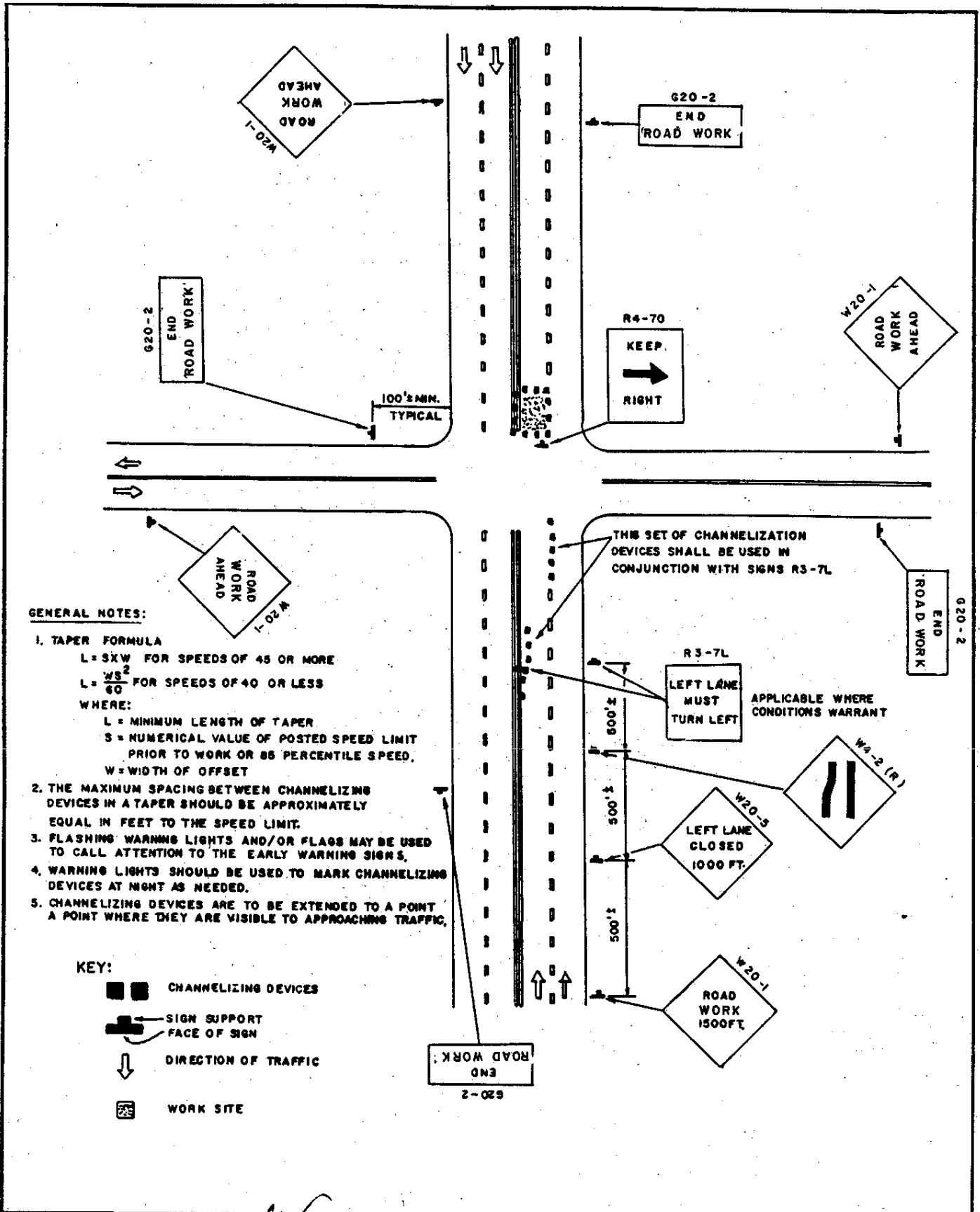

ANNE ARUNDEL COUNTY DEPARTMENT OF PUBLIC WORKS	APPROVED <i>[Signature]</i> CHIEF ENGINEER	STANDARD TRAFFIC CONTROL DETAILS INTERSECTION - TYPICAL LEFT LANE CLOSURE	REVISED	TC 18
	DESIGN ENGINEER 9/17/88 DATE		9-97 <i>RB</i>	

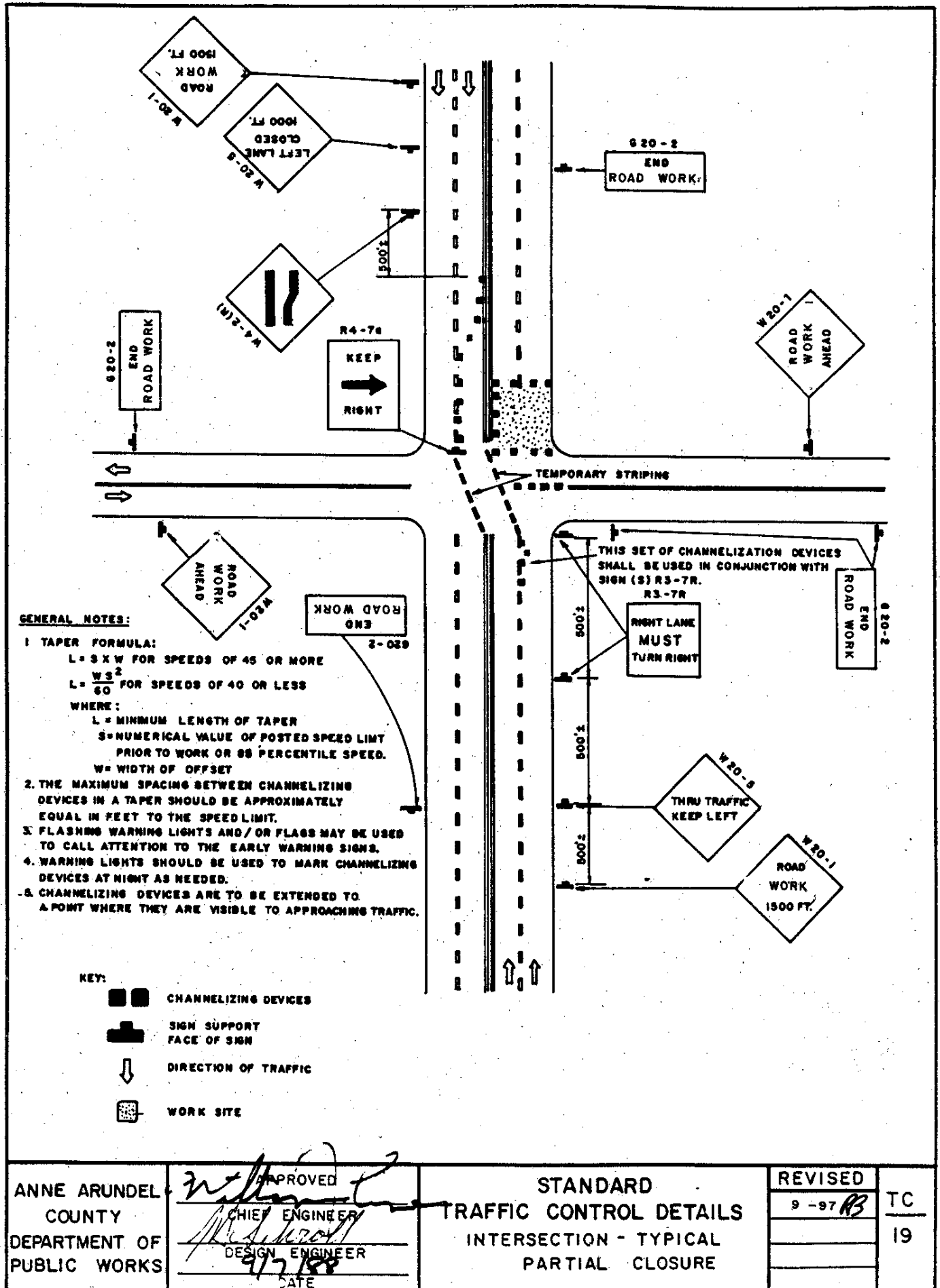

ANNE ARUNDEL COUNTY DEPARTMENT OF PUBLIC WORKS

APPROVED
 CHIEF ENGINEER
 DESIGN ENGINEER
 DATE 9/7/88

STANDARD TRAFFIC CONTROL DETAILS INTERSECTION - TYPICAL PARTIAL CLOSURE

REVISED	TC
9 - 97 RB	
	19

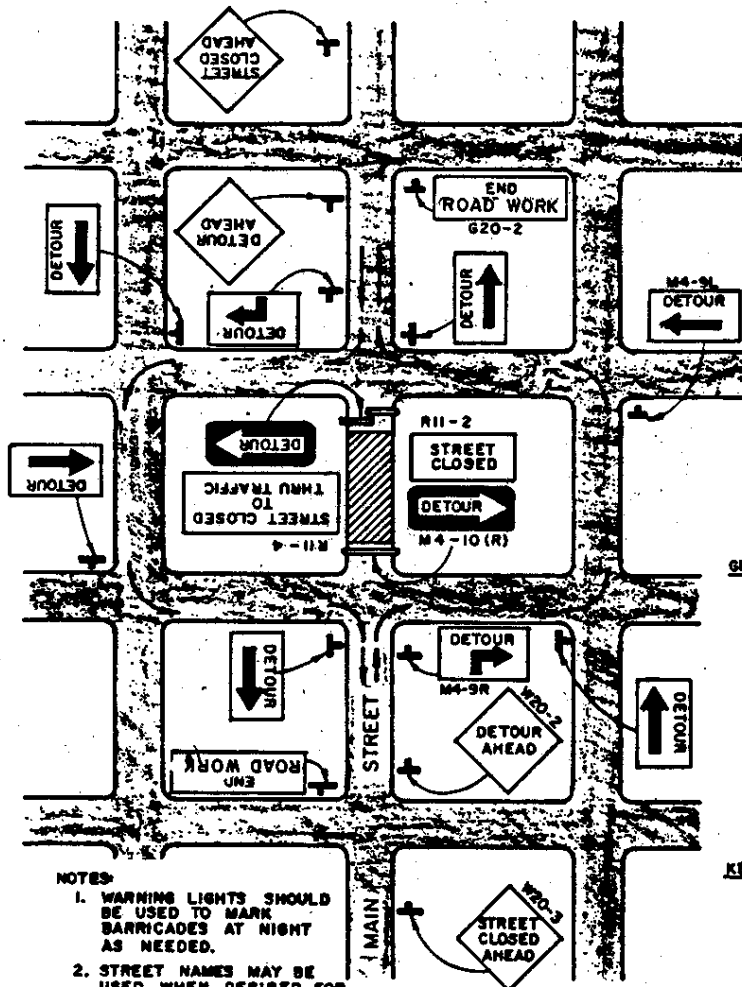





GENERAL NOTES:

1. FLASHING WARNING LIGHTS AND/OR FLAGS MAY BE USED TO CALL ATTENTION TO THE EARLY WARNING SIGNS.
2. WARNING LIGHTS SHOULD BE USED TO MARK BARRICADES AT NIGHT AS NEEDED.
3. PAVEMENT MARKERS NO LONGER APPLICABLE WHICH MIGHT CREATE CONFUSION IN THE MINDS OF VEHICLE OPERATORS SHALL BE REMOVED OR OBLITERATED AS SOON AS PRACTICABLE. TEMPORARY MARKINGS SHALL BE USED AS NECESSARY.

NOTES:

1. WARNING LIGHTS SHOULD BE USED TO MARK BARRICADES AT NIGHT AS NEEDED.
2. STREET NAMES MAY BE USED WHEN DESIRED FOR DIRECTING DETOURED TRAFFIC.

KEY:

-  SIGN SUPPORT FACE OF SIGN
-  DIRECTION OF TRAFFIC
-  TYPE III BARRICADE
-  WORK SITE

ANNE ARUNDEL COUNTY DEPARTMENT OF PUBLIC WORKS	APPROVED  CHIEF ENGINEER	STANDARD TRAFFIC CONTROL DETAILS TYPICAL DETOUR	REVISED 9-97 <i>RB</i>	TC 20
	DESIGN ENGINEER 9/17/00			

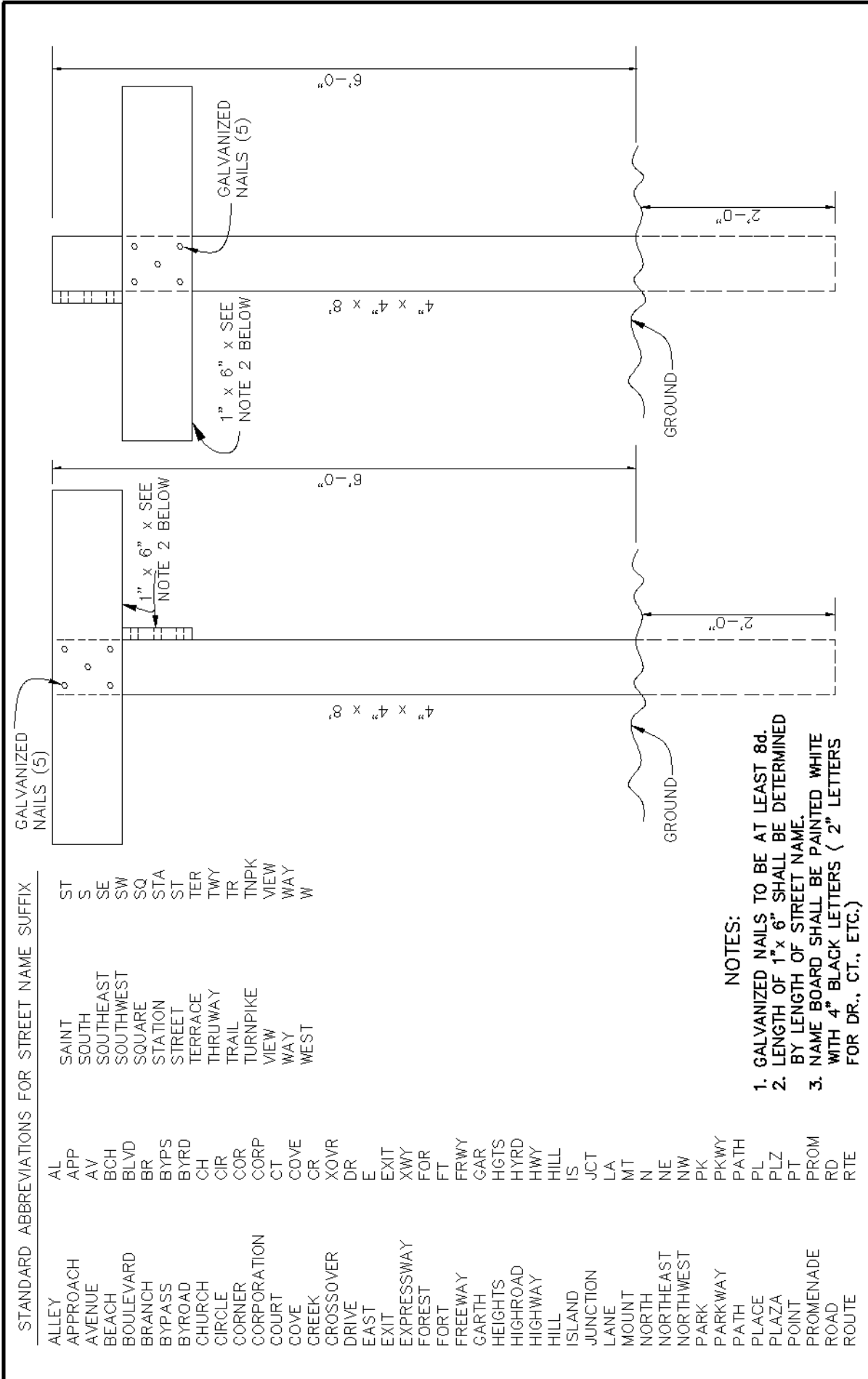

STANDARD ABBREVIATIONS FOR STREET NAME SUFFIX

AL	ALLEY	SAINT	ST
APP	APPROACH	SOUTH	S
AV	AVENUE	SOUTHEAST	SE
BCH	BEACH	SOUTHWEST	SW
BLVD	BOULEVARD	SQUARE	SQ
BR	BRANCH	STATION	STA
BYPASS	BYPASS	STREET	ST
BYRD	BYROAD	TERRACE	TER
CH	CHURCH	THRUWAY	TWY
CIR	CIRCLE	TRAIL	TR
COR	CORNER	TURNPIKE	TNPK
CORP	CORPORATION	VIEW	VIEW
CT	COURT	WAY	WAY
COVE	COVE	WEST	W
CR	CREEK		
XOVR	CROSSOVER		
DR	DRIVE		
E	EAST		
EXIT	EXIT		
XWY	EXPRESSWAY		
FOR	FOREST		
FT	FORT		
FRWY	FREEWAY		
GAR	GARTH		
HGTS	HEIGHTS		
HYRD	HIGHROAD		
HWY	HIGHWAY		
HILL	HILL		
IS	ISLAND		
JCT	JUNCTION		
LA	LANE		
MT	MOUNT		
N	NORTH		
NE	NORTHEAST		
NW	NORTHWEST		
PK	PARK		
PKWY	PARKWAY		
PATH	PATH		
PL	PLACE		
PLZ	PLAZA		
PT	POINT		
PROM	PROMENADE		
RD	ROAD		
RTE	ROUTE		

- NOTES:
1. GALVANIZED NAILS TO BE AT LEAST 8d.
 2. LENGTH OF 1"x 6" SHALL BE DETERMINED BY LENGTH OF STREET NAME.
 3. NAME BOARD SHALL BE PAINTED WHITE WITH 4" BLACK LETTERS (2" LETTERS FOR DR., CT., ETC.)

ANNE ARUNDEL COUNTY DEPARTMENT OF PUBLIC WORKS	APPROVED _____ CHIEF ENGINEER	STANDARD TRAFFIC CONTROL DETAILS TEMPORARY STREET NAME SIGN	REVISED _____ _____ _____	TC 21
	DATE: _____		_____ DESIGN ENGINEER	