

DECK CONSTRUCTION GUIDE

2015 International Residential Code

BUILDING PERMIT #: _____

**DETACHED DECKS REQUIRE
MINIMUM 12" BELOW GRADE
FOOTING PER R403.1.4**

MINIMUM RAILING HEIGHT = 36" ABOVE DECKING WHEN MORE THAN 30" ABOVE THE GRADE. ATTACH RAILING POST TO DECK WITH 3/8" LAG OR CARRIAGE BOLTS WITH WASHERS.

Post Size	Maximum Height
4 x 4	8' - 0"
4 x 6	8' - 0"
6 x 6	14' - 0"
8 x 8	above 15' - 0"

Post supporting a beam splice shall be 6x6 ONLY

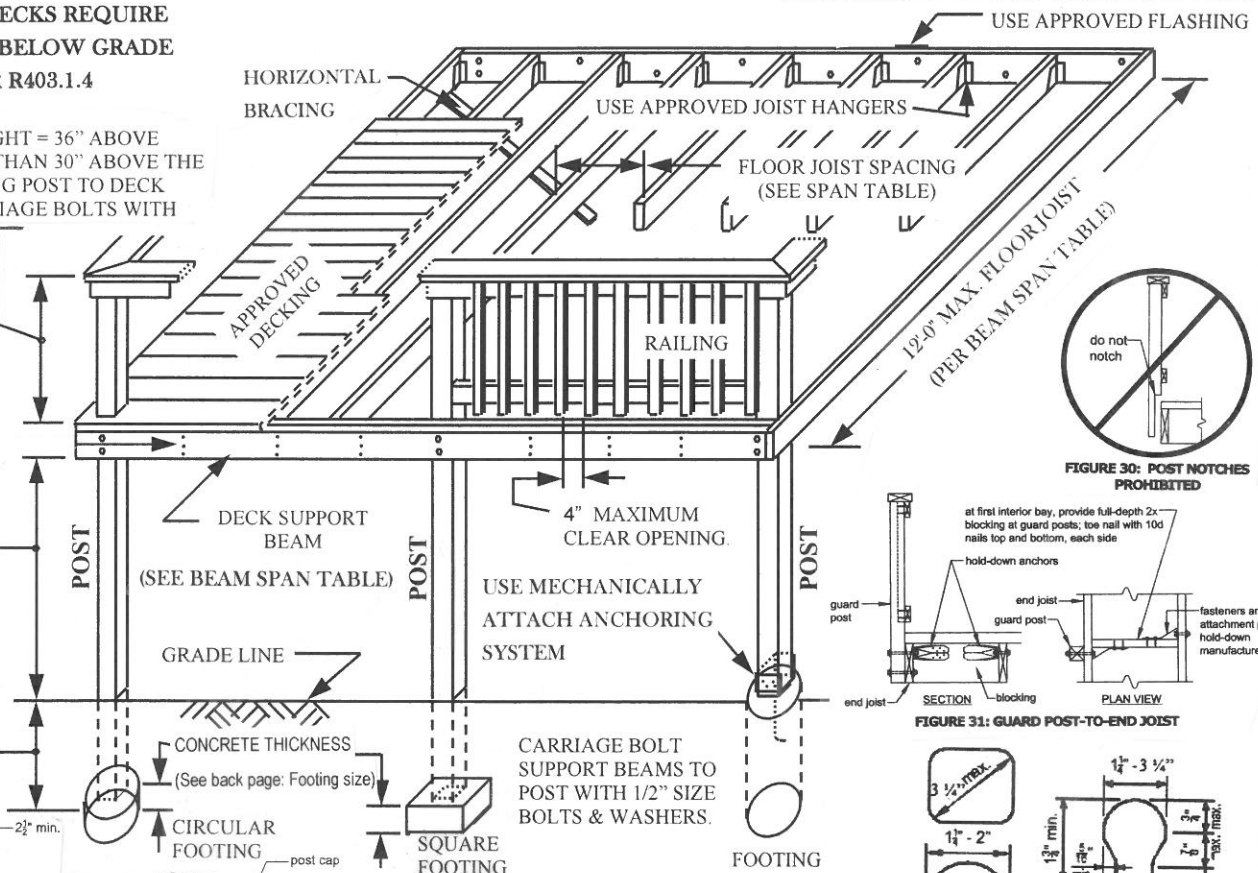

FIGURE 30: POST NOTCHES PROHIBITED

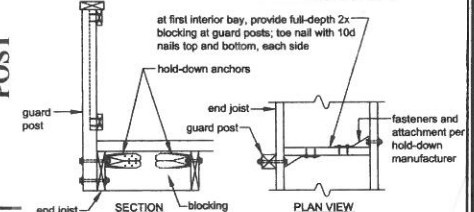

FIGURE 31: GUARD POST-TO-END JOIST

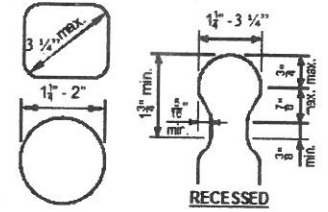

FIGURE 39: HANDRAIL GRASPABILITY

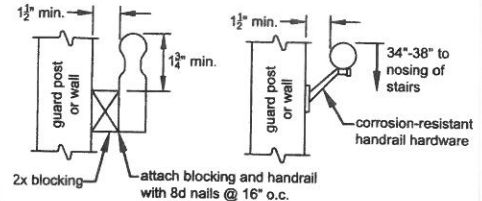
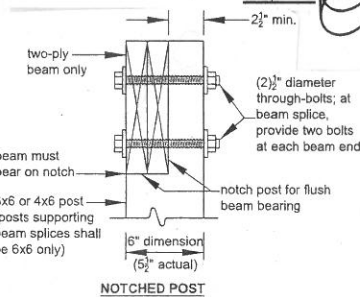
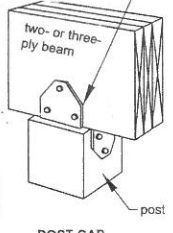

FIGURE 38: HANDRAILS

MINIMUM 30" BELOW GRADE



NOTCHED POST



POST CAP

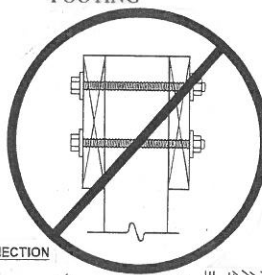

PROHIBITED CONNECTION

POST-TO-BEAM CONNECTIONS

BEAM SIZE: ___ x ___ @ ___ ft. max. span

Beam Size	Maximum Span
2 (2 x 6)	5' - 0"
2 (2 x 8)	6' - 0"
2 (2 x 10)	7' - 6"
2 (2 x 12)	8' - 6"

NOTE: Beam floor loads at mid-span in excess of 6'-0" will require beam upgrade or intermediate beams. Provide layout drawings to scale showing footing & beam locations. Southern Pine #2 PT.

FLOOR JOIST: ___ x ___ @ ___' o/c

FLOOR JOIST CANTILEVER: ___ ft.

Floor Joist Size	Floor Joist Spacing			Maximum Cantilever
	12"	16"	24"	
2 x 6	9' - 11"	9' - 0"	7' - 7"	Not Allowed
2 x 8	13' - 1"	11' - 10"	9' - 8"	2 FT.
2 x 10	16' - 2"	14' - 0"	11' - 5"	3 FT.
2 x 12	19' - 1"	16' - 6"	13' - 6"	4 FT.

NOTE: Lumber species & grade = Southern Pine #2 PT.

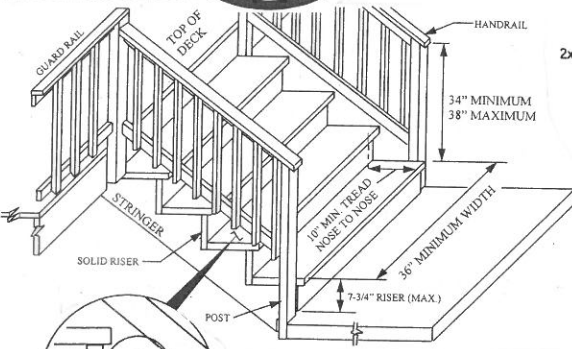

STAIRWAY DETAIL

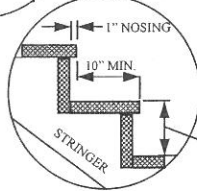
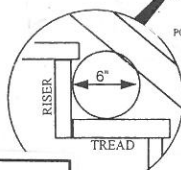

SOLID RISER

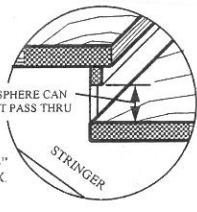

OPEN RISER

NOTES:

- All footing must rest on undisturbed soil.
- Minimum footing size: 16" square or 18" Sonotube. (See back page Table 4: Footing Size)
- DO NOT attach deck ledger to overhanging floor system OR a 2nd beam is required.
- Corrosion resistant fasteners required for all connections.
- Decks are NOT APPROVED for future hot tubs.
- Maintain 20 feet minimum separation from well.
- DO NOT support framing loads on existing chimney.
- Guardrails shall be designed & constructed for a concentrated load of 200 lbs, applied at any point along the top railing member.
- Handgrip portion of handrail shall not be more than 2" in cross section with smooth surface.
- Basement door headroom clearance = 6'-8" (min.)
- Basement egress window path = 36" (min.) clear height

continued @ back page...